

“  
**ARMADI**

---

**WARDROBES**

”

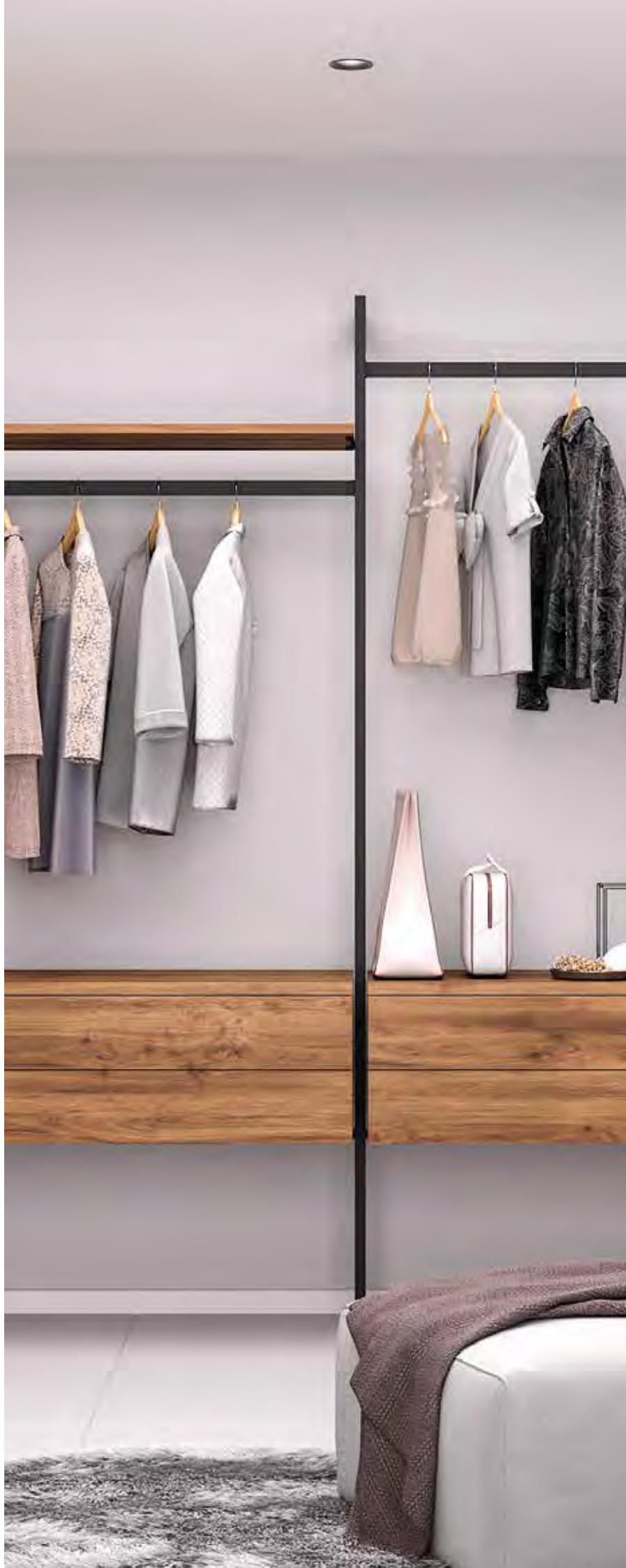



## Porte e accessori per armadi e cabine armadio

### Accessori per interni degli armadi

- 5 Appendiabiti
- 12 Tubi per armadi
- 17 Reggitubi per tubi e di armadi
- 23 Accessori Moka
- 35 Accessori Keeper
- 47 Accessori Self

### Profili e accessori per ante in legno

- 53 Profili maniglia-raddrizza-ante Adige
- 54 Profili maniglia-raddrizza-ante Free Face
- 55 Profili maniglia-raddrizza-ante Free Rapid
- 56 Profili maniglia-raddrizza-ante Styl
- 57 Profili maniglia-raddrizza-ante Rhodes
- 58 Profili maniglia-raddrizza-ante Sparta
- 59 Parapolvere per porte scorrevoli
- 60 Profili per porte Face
- 62 Raddrizza ante

### Strutture modulari

- 65 Struttura modulare Zero in formato kit
- 68 Struttura modulare Zero
- 79 Scaffale Lader
- 80 Struttura Jagmet
- 83 Struttura Tram
- 86 Supporti per struttura Tram

### Ante in alluminio

- 96 Porte Free
- 89 Profili Plus
- 92 Accessori per profili Plus

## Doors and accessories for wardrobes and dressing rooms

### Accessories for inside wardrobes

- 5 Wardrobe pull down rail
- 12 Wardrobe interior wardrobe rails
- 17 Supports for wardrobe interior wardrobe rails
- 23 Moka accessories
- 35 Keeper accessories
- 47 Self Accessories

### Profiles and accessories for wooden doors

- 53 Adige handle profiles
- 54 Free Face handle profiles
- 55 Free Rapid handle profiles
- 56 Styl handle profiles
- 57 Rhodes handle profiles
- 58 Sparta handle profiles
- 59 Dust excluder strips
- 60 Edging profiles Face
- 62 Door truss

### Modular shelving

- 65 Modular structure Zero in kit form
- 68 Modular structure Zero
- 79 Lader Bookcases
- 80 Jagmet structure
- 83 Tram structure
- 86 Supports for Tram structure

### Aluminium doors

- 96 Free doors
- 89 Plus profiles
- 92 Accessories for Plus profiles





“

INTERNI DEGLI ARMADI

---

ACCESSORIES FOR  
INSIDE WARDROBES

”

APPENDIABILI // WARDROBE PULL DOWN RAIL

Appendiabiti per armadio

Folding hanger for wardrobe



Larghezza Width	Finitura Finishing	Imballo Packaging	Cod.
450 - 600	Cromato brillo Chrome plated	1 UN/Ut.	7030011
450 - 600	Titanio Titanium	1 UN/Ut.	7030052
450 - 600	Plastica bianca White plastic	1 UN/Ut.	7030015
600 - 830	Titanio Titanium	1 UN/Ut.	7030152
600 - 830	Plastica bianca White plastic	1 UN/Ut.	7030115
600 - 830	Cromato brillo Chrome plated	1 UN/Ut.	7030111
830 - 1150	Plastica bianca White plastic	1 UN/Ut.	7030215
830 - 1150	Cromato brillo Chrome plated	1 UN/Ut.	7030211
830 - 1150	Titanio Titanium	1 UN/Ut.	7030252

Acciaio, Tecnoplastica Plastic, Steel

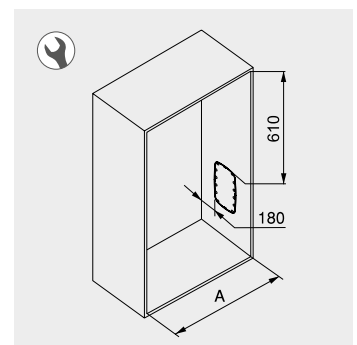
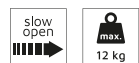

Tappi di copertura estetica inclusi per nascondere le viti.  
Disponibili coperture estetiche con effetto tessuto.  
Incluse viti di montaggio.  
L'asta di manovra dispone di sistema frizionato anti-dondolio.  
Barra centrale regolabile in larghezza.  
Plastica paracolpo in apertura integrato.

Side covers included to hide the installation screws.  
Also available are cover caps in textile effect.  
Includes mounting screws.  
The handle bar has a fixing system that reduces its swing-back.  
Central bar can be adjusted in width.  
Integrated opening bumper stop.

Distanziatore Sling per appendiabiti Hang

Sling stopper for drop bar Sling

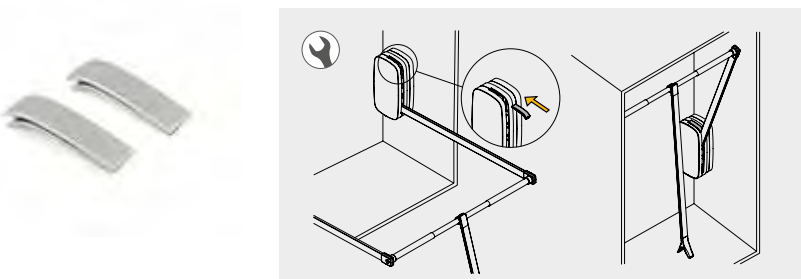

Finitura Finishing	Imballo Packaging	Cod.
Plastica bianca White plastic	6 UN/Ut.	7030415
Verniciato alluminio Silver painted	6 UN/Ut.	7030425
Plastica titanio Titanium plastic	6 UN/Ut.	7030438

Tecnoplastica Plastic

Permette di montare Sling nel fondo dell'armadio.

Allows Sling to be mounted to the back of the wardrobe.



APPENDIABILI // WARDROBE PULL DOWN RAIL

Spessore laterale Sling

Sling Side supplement

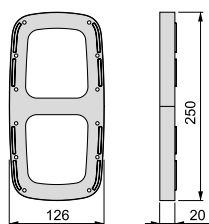
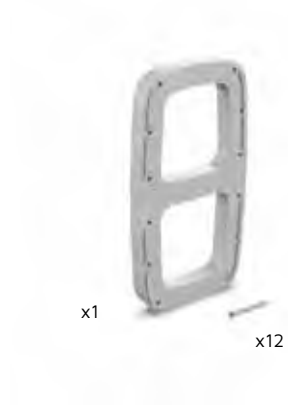

Finitura Finishing	Imballo Packaging	Cod.
Plastica bianca White plastic	1 Set/Set	7067315
Verniciato alluminio Silver painted	1 Set/Set	7067325
Plastica titanio Titanium plastic	1 Set/Set	7067338

Tecnoplastica Plastic

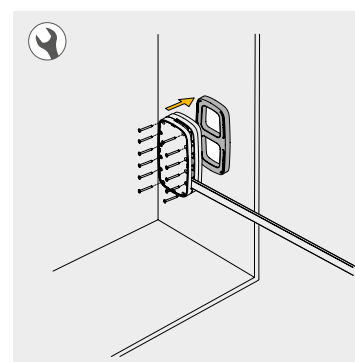

Kit di tappi Sling con feltro per appendiabiti Sling

Sing set covers with felt for drop bar Sling

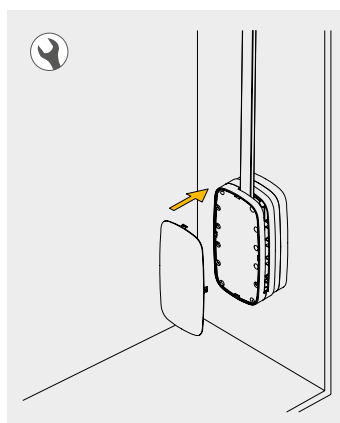

Finitura Finishing	Imballo Packaging	Cod.
Effetto tessuto grigio Grey textil effect	6 UN/Ut.	7030527
Effetto tessuto noce Brown textile effect	6 UN/Ut.	7030529
Effetto tessuto beige Beige textil effect	6 UN/Ut.	7030528
Effetto stoffa Cloth effect	6 UN/Ut.	7030534

Tecnoplastica Plastic

Si possono personalizzare. Richiedere condizioni.

Customizable. Contact us for details.







APPENDIABILI // WARDROBE PULL DOWN RAIL

Appendiabiti per armadio Hang

Hang folding hanger for wardrobes

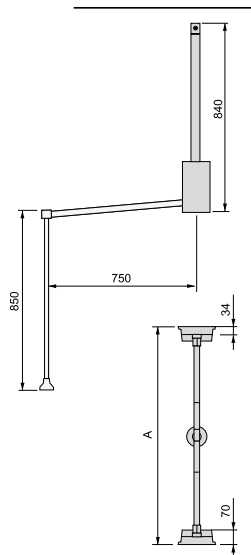
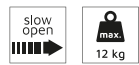

A	Finitura Finishing	Imballo Packaging	Cod.
450 - 600	Cromato brillo Chrome plated	1 UN/Ut.	9283711
450 - 600	Verniciato nero Black painted	1 UN/Ut.	9283714
450 - 600	Verniciato moka Moka painted	1 UN/Ut.	9283713
600 - 830	Verniciato nero Black painted	1 UN/Ut.	9283814
600 - 830	Verniciato moka Moka painted	1 UN/Ut.	9283813
600 - 830	Cromato brillo Chrome plated	1 UN/Ut.	9283811
830 - 1150	Verniciato moka Moka painted	1 UN/Ut.	9283913
830 - 1150	Cromato brillo Chrome plated	1 UN/Ut.	9283911
830 - 1150	Verniciato nero Black painted	1 UN/Ut.	9283914

Acciaio, Tecnoplastica Plastic, Steel

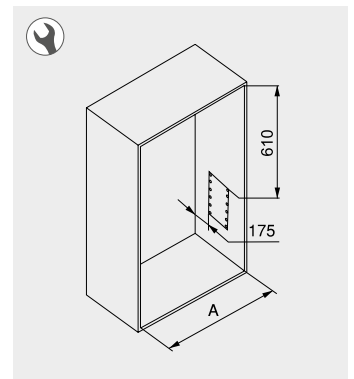

Hang a parete

Wall-mounted Hang

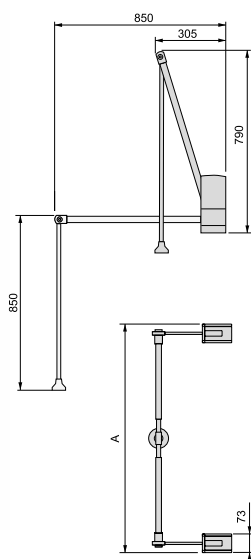

A	Finitura Finishing	Imballo Packaging	Cod.
600-830	Cromato brillo Chrome plated	1 UN/Ut.	6037811

Acciaio, Tecnoplastica Plastic, Steel



APPENDIABITI // WARDROBE PULL DOWN RAIL

Distanziatore Hang per appendiabiti Hang

Hang stopper for Hang folding bar

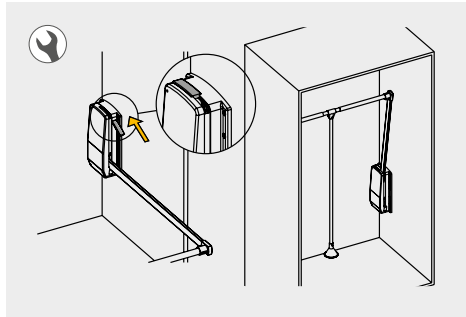

Finitura Finishing	Imballo Packaging	Cod.
Verniciato alluminio Silver painted	6 UN/Ut.	8285425

Tecnoplastica Plastic

Spessore laterale per appendiabiti Hang

Side supplement for Hang Lift pull down wardrobe rail

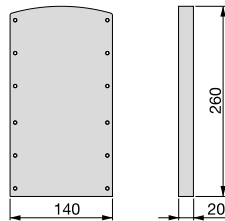

Finitura Finishing	Imballo Packaging	Cod.
Verniciato alluminio Silver painted	1 Set/Set	7085025
Verniciato moka Moka painted	1 Set/Set	7085013
Plastica nera Black plastic	1 Set/Set	7085017

Tecnoplastica Plastic

Supporto per appendiabiti Hang

Support for Hang wardrobe lift



Finitura Finishing	Imballo Packaging	Cod.
Verniciato alluminio Silver painted	1 UN/Ut.	6108225

Acciaio, Zama Steel, Zamak



**TUBI PER ARMADI // WARDROBE INTERIOR WARDROBE RAILS**

**Kit tubo per armadio Silk**



**Wardrobe hanging rail kit Silk**



Possibilità di personalizzare su misura.  
Can be cut to size.

Con gomma in PVC semirigida per evitare lo strisciare della gruccia.

With semi-hard P.V.C profile to avoid coathanger noise and scratches.

Lunghezza Longitude	Finitura Finishing	Imballo Packaging	Cod.
1,15 m	Anodizzato opaco Matt anodized	 1 UN/Ut.	7070062
0,75 m	Anodizzato opaco Matt anodized	 1 UN/Ut.	7070162

Alluminio, Tecnoplastica  
Aluminium, Plastic

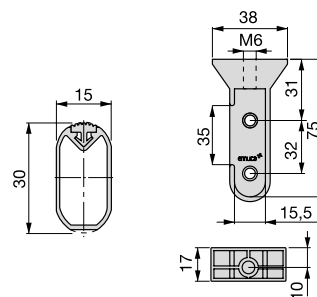



**Kit tubo per armadio 30x15 mm alluminio**

**Wardrobe hanging rail kit 30x15 mm aluminium**



Possibilità di personalizzare su misura.  
Can be cut to size.

Lunghezza Longitude	Finitura Finishing	Imballo Packaging	Cod.
1,15 m	Anodizzato opaco Matt anodized	 1 UN/Ut.	7070262
0,75 m	Anodizzato opaco Matt anodized	 1 UN/Ut.	7070362

Alluminio, Zama  
Aluminium, Zamak

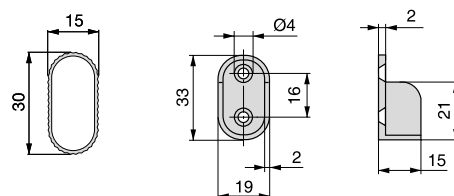

**TUBI PER ARMADI // WARDROBE INTERIOR WARDROBE RAILS**

**Kit tubo per armadio 30x15 mm acciaio**

**Wardrobe hanging rail kit 30x15 mm steel**



Lunghezza Longitude	Finitura Finishing	Imballo Packaging	Cod.
1,15 m	Cromato brillo Chrome plated	1 UN/Ut.	7070411
0,75 m	Cromato brillo Chrome plated	1 UN/Ut.	7070511

Acciaio, Zama  
Steel, Zamak

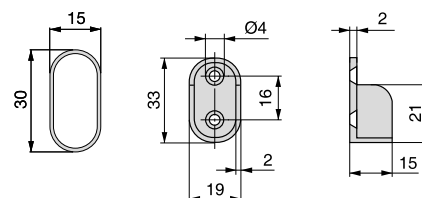

Possibilità di personalizzare su misura.  
Can be cut to size.

**Kit tubo per armadio rotondo Ø28**

**Wardrobe hanging rail kit round Ø28**



Lunghezza Longitude	Finitura Finishing	Imballo Packaging	Cod.
1,15 m	Verniciato moka Moka painted	1 UN/Ut.	7070613
1,15 m	Anodizzato opaco Matt anodized	1 UN/Ut.	7070662
0,75 m	Verniciato moka Moka painted	1 UN/Ut.	7070713
0,75 m	Anodizzato opaco Matt anodized	1 UN/Ut.	7070762

Alluminio, Zama  
Aluminium, Zamak

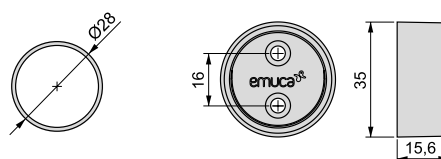

Possibilità di personalizzare su misura.  
Can be cut to size.



**TUBI PER ARMADI // WARDROBE INTERIOR WARDROBE RAILS**

**Appendiabiti rettangolare Luxe per armadio**

**Luxe rectangular wardrobe rail kit**

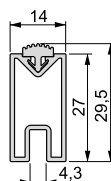

Lunghezza Longitude	Finitura Finishing	Imballo Packaging	Cod.
2,35 m	Anodizzato opaco Matt anodized		10 UN./Ut. 7100862
2,35 m	Verniciato moka Moka painted		10 UN./Ut. 7100813

Alluminio  
Aluminium



Possibilità di personalizzare su misura.  
Can be cut to size.

Con gomma in PVC semirigida per evitare lo strisciare della gruccia.

With semi-hard P.V.C profile to avoid coathanger noise and scratches.

**barra per armadio rotonda Ø28**

**Ø28 round wardrobe rail**

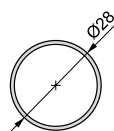

Lunghezza Longitude	Finitura Finishing	Imballo Packaging	Cod.
2,35 m	Anodizzato opaco Matt anodized		10 UN./Ut. 6057862
2,35 m	Verniciato moka Moka painted		10 UN./Ut. 6057813
2,35 m	Verniciato nero Black painted		10 UN./Ut. 6057814
2,35 m	Verniciato titanio Titanium painted		10 UN./Ut. 6057873

5.0  
5.0



Possibilità di personalizzare su misura.  
Can be cut to size.



**TUBI PER ARMADI // WARDROBE INTERIOR WARDROBE RAILS**

**Appendiabiti per armadio Silk**

**Silk wardrobe rail kit**

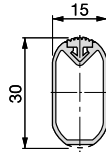

Lunghezza Longitude	Finitura Finishing	Imballo Packaging	Cod.
2,35 m	Anodizzato opaco Matt anodized	 10 UN/Ut.	6072162
2,35 m	Verniciato nero Black painted	 10 UN/Ut.	6072114

Alluminio  
Aluminium



Possibilità di personalizzare su misura.  
Can be cut to size.



Con gomma in PVC semirigida per evitare lo strisciare della gruccia.

With semi-hard P.V.C profile to avoid coathanger noise and scratches.

**Kit barra in alluminio per armadio**

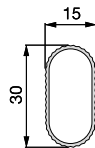
**aluminium wardrobe rail**



Lunghezza Longitude	Finitura Finishing	Imballo Packaging	Cod.
2,35 m	Anodizzato opaco Matt anodized	 10 UN/Ut.	6220362
3,9 m	Anodizzato opaco Matt anodized	 15 UN/Ut.	6220262

Alluminio  
Aluminium



Possibilità di personalizzare su misura.  
Can be cut to size.

**Kit barra in acciaio per armadio**

**steel wardrobe rail**

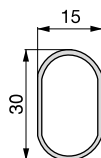

Lunghezza Longitude	Finitura Finishing	Imballo Packaging	Cod.
2,35 m	Cromato brillo Chrome plated	 10 UN/Ut.	7009411

Acciaio  
Steel



Possibilità di personalizzare su misura.  
Can be cut to size.



REGGITUBI PER TUBI E DI ARMADI // SUPPORTS FOR WARDROBE INTERIOR WARDROBE RAILS

Set di supporti per barra da armadio Luxe

Luxe wardrobe rail support set

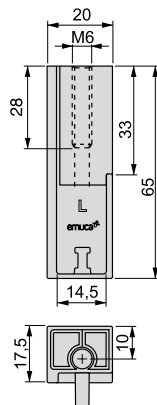

Finitura Finishing	Imballo Packaging	Cod.
Verniciato alluminio Silver painted	10 Set/Set	7102025
Verniciato moka Moka painted	10 Set/Set	7102013

Zama Zamak

Per la misura della barra aggiungere 10 mm all'interasse di foratura dei reggitubi.

To calculate the measurement of the bar, subtract 10 mm from the inter-axis of the end support.

Supporto centrale per barra armadio Luxe

Luxe wardrobe rail central support

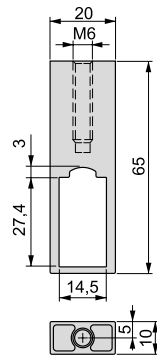

Finitura Finishing	Imballo Packaging	Cod.
Verniciato alluminio Silver painted	20 UN/Ut.	7100325
Verniciato moka Moka painted	20 UN/Ut.	7100313

Zama Zamak

Supporto angolare per barra armadio Luxe

Luxe wardrobe rail angular support

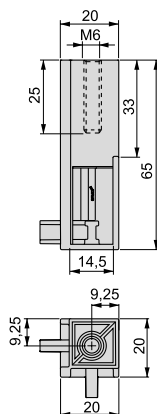

Finitura Finishing	Imballo Packaging	Cod.
Verniciato alluminio Silver painted	20 UN/Ut.	7100225
Verniciato moka Moka painted	20 UN/Ut.	7100213

Zama Zamak

Supporto per barra armadio Luxe

Luxe wardrobe rail support

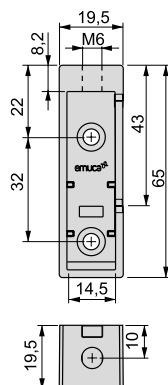

Lato Hand	Finitura Finishing	Imballo Packaging	Cod.
Destra Right	Verniciato alluminio Silver painted	100 UN/Ut.	7100525
Destra Right	Plastica moka Moka plastic	100 UN/Ut.	7100543
Sinistra Left	Verniciato alluminio Silver painted	100 UN/Ut.	7100425
Sinistra Left	Plastica moka Moka plastic	100 UN/Ut.	7100443

Tecnoplastica Plastic

Per calcolare la misura del tubo, togliere 11 mm alla misura del vano.

To calculate the measurement of the rail subtract 11 mm from the internal width.



**REGGITUBI PER TUBI E DI ARMADI // SUPPORTS FOR WARDROBE INTERIOR WARDROBE RAILS**

**Set di supporti per barra per armadio Luxe Ø28**

**Ø28 wardrobe rail support set**

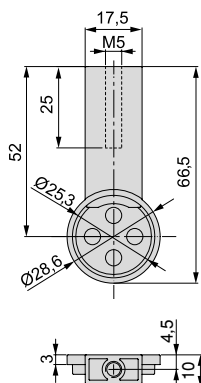

Per la misura della barra aggiungere 3 mm all'interasse di foratura dei reggitubi.

To calculate the measurement of the bar, subtract 3 mm from the inter-axis of the end support.

Finitura Finishing	Imballo Packaging	Cod.
Verniciato alluminio Silver painted	10 Set/Set	7922525
Verniciato moka Moka painted	10 Set/Set	7922513
Verniciato nero Black painted	10 Set/Set	7922514
Verniciato titanio Titanium painted	10 Set/Set	7922573

Zama Zamak

**Supporto centrale per barra armadio Luxe Ø28**

**Ø28 wardrobe rail central support**

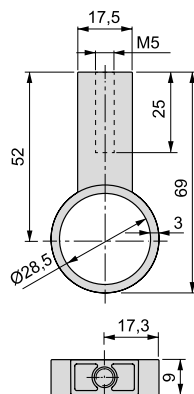

**Supporto laterale per barra armadio Luxe Ø28**

**Ø28 wardrobe rail lateral support**

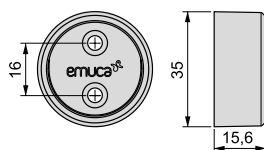

Per calcolare la misura del tubo, togliere 6 mm alla misura del vano.

To calculate the measurement of the rail subtract 6 mm from the internal width.

Finitura Finishing	Imballo Packaging	Cod.
Plastica moka Moka plastic	50 UN/Ut.	7919843
Plastica grigia Grey plastic	50 UN/Ut.	7919821
Plastica nera Black plastic	50 UN/Ut.	7919817

Tecnoplastica, Zama Plastic, Zamak



**REGGITUBI PER TUBI E DI ARMADI // SUPPORTS FOR WARDROBE INTERIOR WARDROBE RAILS**

**Set di supporti per barra per armadio Silk**

Silk wardrobe rail support set

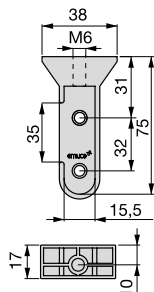

Per calcolare la misura del tubo, togliere 7 mm alla misura del vano.

To calculate the measurement of the rail subtract 7 mm from the internal width.

Finitura Finishing	Imballo Packaging	Cod.
Verniciato alluminio Silver painted	10 Set/Set	7101025
Verniciato nero Black painted	10 Set/Set	7101014

Tecnoplastica Plastic

**Supporto centrale per barra armadio Silk**

Silk wardrobe rail central support

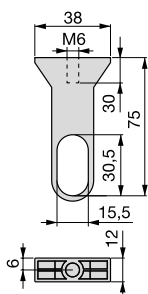

Finitura Finishing	Imballo Packaging	Cod.
Verniciato alluminio Silver painted	20 UN/Ut.	6003125
Verniciato nero Black painted	20 UN/Ut.	6003114

Tecnoplastica Plastic

**Supporto angolare per barra armadio Silk**

Silk wardrobe rail angular support

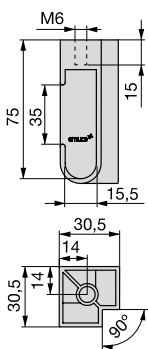

Finitura Finishing	Imballo Packaging	Cod.
Verniciato alluminio Silver painted	20 UN/Ut.	6003225
Verniciato nero Black painted	20 UN/Ut.	6003214

Tecnoplastica Plastic

**Supporto laterale per barra armadio 90168**

Wardrobe rail lateral support 90168

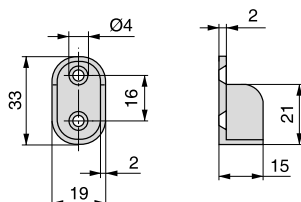

Finitura Finishing	Imballo Packaging	Cod.
Nichelato Nickel plated	500 UN/Ut.	9016807
Verniciato alluminio Silver painted	500 UN/Ut.	9016825

Zama Zamak

REGGITUBI PER TUBI E DI ARMADI // SUPPORTS FOR WARDROBE INTERIOR WARDROBE RAILS

Supporto laterale per barra armadio a montaggio diretto

Direct assembly wardrobe rail lateral support

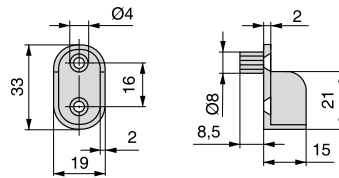

Finitura Finishing	Imballo Packaging	Cod.
Nichelato Nickel plated	500 UN/Ut.	9016707

Zama Zamak

Supporto laterale per barra armadio 40070

Wardrobe rail lateral support 40070

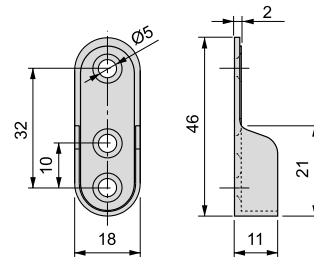

Finitura Finishing	Imballo Packaging	Cod.
Nichelato Nickel plated	500 UN/Ut.	4007007

Acciaio Steel

Supporto laterale per barra armadio 70143

Wardrobe rail lateral support 70143

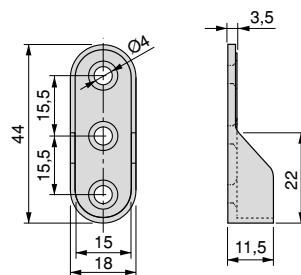

Finitura Finishing	Imballo Packaging	Cod.
Nichelato Nickel plated	500 UN/Ut.	7014307

Zama Zamak

Supporto laterale per barra armadio 71468

Wardrobe rail lateral support 71468

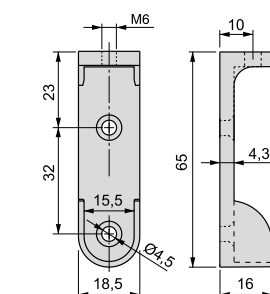

Finitura Finishing	Imballo Packaging	Cod.
Nichelato Nickel plated	250 UN/Ut.	7146807
Verniciato alluminio Silver painted	250 UN/Ut.	7146825

Zama Zamak

REGGITUBI PER TUBI E DI ARMADI // SUPPORTS FOR WARDROBE INTERIOR WARDROBE RAILS

Supporto laterale per barra armadio 60474

Wardrobe rail lateral support 60474

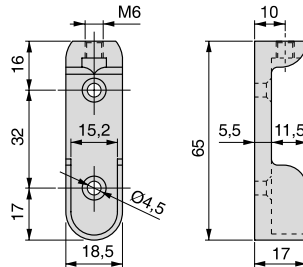

Finitura Finishing	Imballo Packaging	Cod.
Nichelato Nickel plated	200 UN/Ut.	6047407
Verniciato alluminio Silver painted	200 UN/Ut.	6047425

Zama Zamak

Supporto laterale per barra armadio 60026

Wardrobe rail lateral support 60026

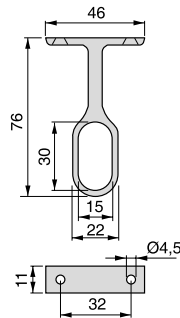

Finitura Finishing	Imballo Packaging	Cod.
Nichelato Nickel plated	300 UN/Ut.	6002607
Verniciato alluminio Silver painted	300 UN/Ut.	6002625

Zama Zamak

Supporto centrale per barra per armadio 81203

Wardrobe rail central support 81203

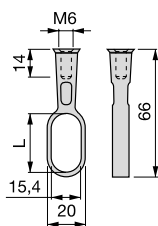

L	Finitura Finishing	Imballo Packaging	Cod.
30	Verniciato alluminio Silver painted	500 UN/Ut.	8120325

Zama Zamak

Base supporto centrale per barra armadio

Wardrobe rail central support base

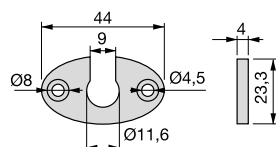

Finitura Finishing	Imballo Packaging	Cod.
Verniciato alluminio Silver painted	500 UN/Ut.	8120425

Zama Zamak





**ACCESSORI MOKA // MOKA ACCESSORIES**

**Telaio Moka con guide**

**Moka frame with runners**

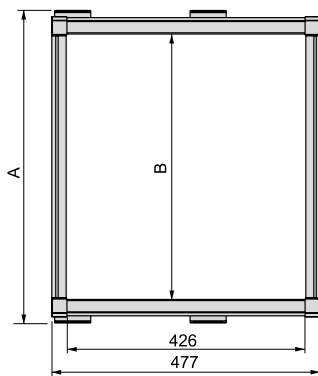
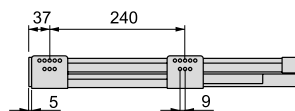
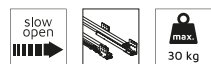

A	B	Finitura Finishing	Imballo Packaging	Cod.
564 - 614	484	Verniciato moka Moka painted	1 UN/Ut.	6930013
614 - 664	534	Verniciato moka Moka painted	1 UN/Ut.	6929913
664 - 714	584	Verniciato moka Moka painted	1 UN/Ut.	6930113
714 - 764	634	Verniciato moka Moka painted	1 UN/Ut.	6930613
764 - 814	684	Verniciato moka Moka painted	1 UN/Ut.	6930213
814 - 864	734	Verniciato moka Moka painted	1 UN/Ut.	6930713
864 - 914	784	Verniciato moka Moka painted	1 UN/Ut.	6930313
914 - 964	834	Verniciato moka Moka painted	1 UN/Ut.	6930813
964 - 1.014	884	Verniciato moka Moka painted	1 UN/Ut.	6930413
1.014 - 1.064	934	Verniciato moka Moka painted	1 UN/Ut.	6930913
1.064 - 1.114	984	Verniciato moka Moka painted	1 UN/Ut.	6930513

Alluminio, Tecnoplastica  
Aluminium, Plastic

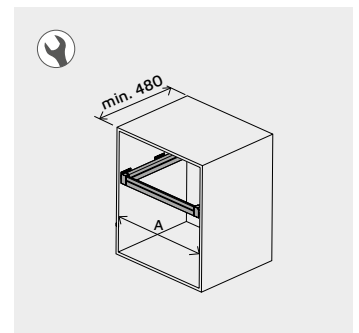

**Set di distanziali per accessori estraibili Moka**

**Set of spacers for removable Moka**



Finitura Finishing	Imballo Packaging	Cod.
Plastica moka Moka plastic	4 Set/Set	6939943

Tecnoplastica  
Plastic

Da utilizzarsi con l'uso di ante con cerniera o scorrevoli che restano interne alla luce del mobile.  
Vite raccomandata Ø4x40.

To be used with hinged doors or as a spacer for hollow modules.  
Recommended screw Ø4x40.

ACCESSORI MOKA // MOKA ACCESSORIES

Cassetto metallico Moka per armadio

Metallic drawer Moka for wardrobes

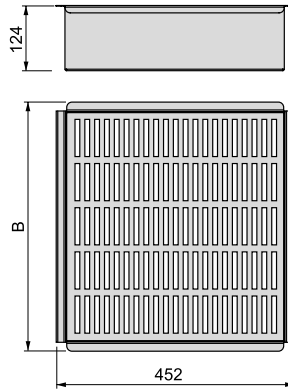

B	Finitura Finishing	Imballo Packaging	Cod.
475	Verniciato moka Moka painted	1 UN/Ut.	6932013
675	Verniciato moka Moka painted	1 UN/Ut.	6932113
775	Verniciato moka Moka painted	1 UN/Ut.	6932213

Acciaio Steel

Cassetto in filo Moka per armadio

Wire drawer Moka for wardrobes

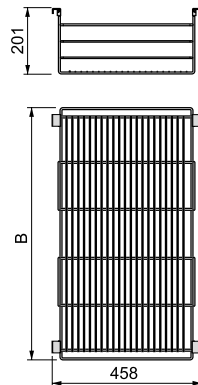

B	Finitura Finishing	Imballo Packaging	Cod.
475	Verniciato moka Moka painted	2 UN/Ut.	6933013
675	Verniciato moka Moka painted	2 UN/Ut.	6933113
775	Verniciato moka Moka painted	2 UN/Ut.	6933213

Acciaio Steel

Porta scarpe Moka per armadio

Shoe drawer Moka for wardrobes

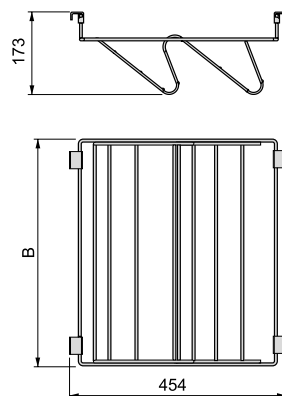
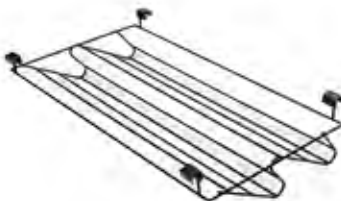

B	Finitura Finishing	Imballo Packaging	Cod.
475	Verniciato moka Moka painted	2 UN/Ut.	6937013
675	Verniciato moka Moka painted	2 UN/Ut.	6937113
775	Verniciato moka Moka painted	2 UN/Ut.	6937213

Acciaio Steel









**ACCESSORI MOKA // MOKA ACCESSORIES**

**Cassetto organizzatore Moka per armadio**

Organizer drawer Moka for wardrobes

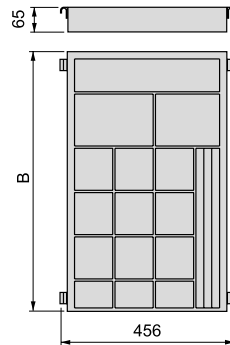

B	Finitura Finishing	Imballo Packaging	Cod.
483	Legno noce Walnut wood	1 UN/Ut.	6931075
683	Legno noce Walnut wood	1 UN/Ut.	6931175
783	Legno noce Walnut wood	1 UN/Ut.	6931275

Legno  
Wood

**Cesto portabiancheria Moka per armadio**

Basket Moka for wardrobes

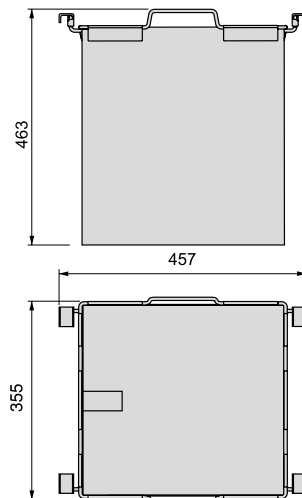

B	Finitura Finishing	Imballo Packaging	Cod.
355	Verniciato moka Moka painted	1 UN/Ut.	6934213

Acciaio, Tessuto  
Fabric, Steel

**Vaschetta ausiliare Moka per armadio**

Auxiliary tray Moka for wardrobes

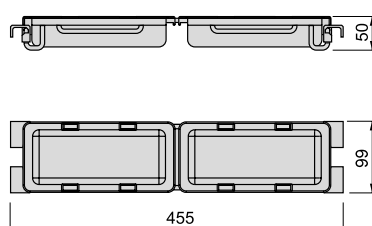

B	Finitura Finishing	Imballo Packaging	Cod.
99	Verniciato moka Moka painted	1 UN/Ut.	6939613

Alluminio, Tecnoplastica  
Aluminium, Plastic

**ACCESSORI MOKA // MOKA ACCESSORIES**

**Set di 7 aste porta pantaloni Moka per armadio**

Set of 7 trousers rods Moka for wardrobes



x7

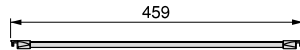

Finitura Finishing	Imballo Packaging	Cod.
Verniciato moka Moka painted	1 UN/Ut.	6934013

Alluminio, Tecnoplastica  
Aluminium, Plastic

**Pinze appendiabiti Moka per armadio**

Hanging clip Moka for wardrobes

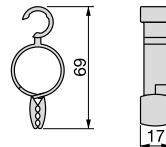

Finitura Finishing	Imballo Packaging	Cod.
Plastica moka Moka plastic	10 UN/Ut.	6934143

Tecnoplastica  
Plastic

**Cassetto porta-scarpe estraibile Moka**

Moka pull out shoe rack drawer

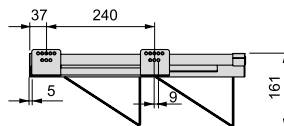

A	M	Finitura Finishing	Imballo Packaging	Cod.
564 - 594	600 mm	Verniciato moka Moka painted	1 UN/Ut.	6936013
764 - 794	800 mm	Verniciato moka Moka painted	1 UN/Ut.	6936113
864 - 894	900 mm	Verniciato moka Moka painted	1 UN/Ut.	6936213

Acciaio  
Steel

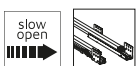
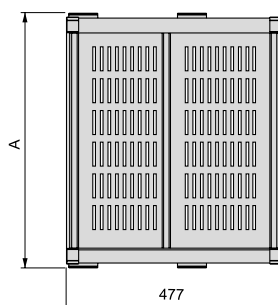







**ACCESSORI MOKA // MOKA ACCESSORIES**

**Porta scarpe laterale estraibile Moka**

Moka pull out lateral shoe rack



Descrizioni Description	Lato Hand	Finitura Finishing	Imballo Packaging	Cod.
Sinistra Left	Sinistra Left	Verniciato moka Moka painted	1 UN/Ut.	6938413
Destra Right	Destra Right	Verniciato moka Moka painted	1 UN/Ut.	6938513

Acciaio  
Steel

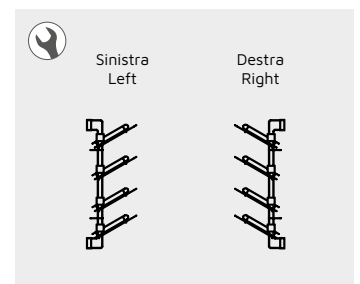
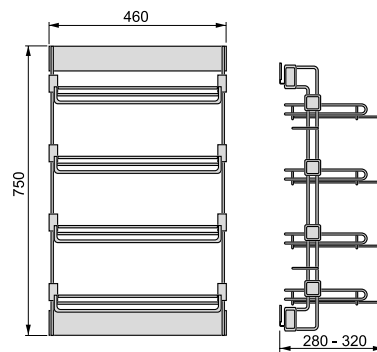
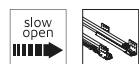

**Appendiabiti estraibile Moka per armadio**

Moka extractable hanger for wardrobe



Finitura Finishing	Imballo Packaging	Cod.
Verniciato moka Moka painted	1 UN/Ut.	6938713

Alluminio, Tecnoplastica  
Aluminium, Plastic

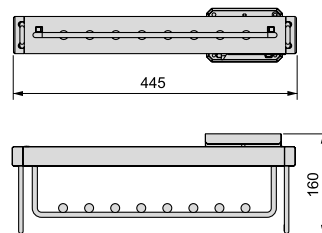
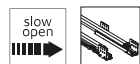

**Porta cravatte laterale estraibile Moka**

Moka extractable lateral tie rack



Finitura Finishing	Imballo Packaging	Cod.
Verniciato moka Moka painted	1 UN/Ut.	6938813

Alluminio, Tecnoplastica  
Aluminium, Plastic

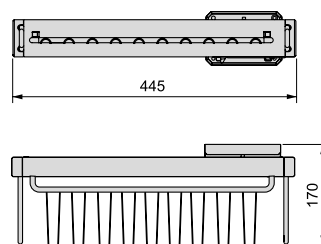



ACCESSORI MOKA // MOKA ACCESSORIES

Specchio estraibile per interno di armadio Moka

Moka extractable mirror for inside wardrobe

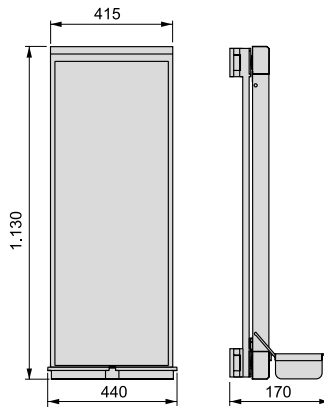

Larghezza Width	Finitura Finishing	Imballo Packaging	Cod.
440	Verniciato moka Moka painted	1 UN/Ut.	6938613

Alluminio, Tecnoplastica  
Aluminium, Plastic

Specchio estraibile per interni di armadio.

Pull-out mirror for inside wardrobe.

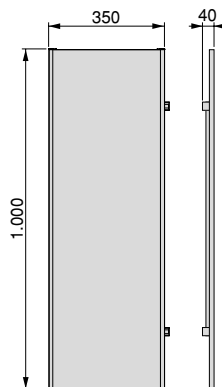

Finitura Finishing	Imballo Packaging	Cod.
Verniciato moka Moka painted	1 UN/Ut.	7018013
Verniciato alluminio Silver painted	1 UN/Ut.	7018025

Acciaio, Tecnoplastica, Vetro  
Glass, Plastic, Steel

Porta pantaloni estraibile

pull-out trouser rack

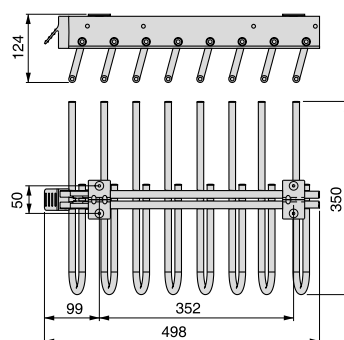

Lato Hand	Finitura Finishing	Imballo Packaging	Cod.
Sinistra Left	Verniciato moka Moka painted	1 UN/Ut.	6912813
Sinistra Left	Verniciato alluminio Silver painted	1 UN/Ut.	6912825
Destra Right	Verniciato moka Moka painted	1 UN/Ut.	6923413
Destra Right	Verniciato alluminio Silver painted	1 UN/Ut.	6923425

Acciaio, Tecnoplastica  
Plastic, Steel

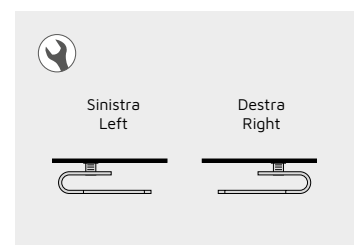





**ACCESSORI KEEPER // KEEPER ACCESSORIES**

Guide Keeper per armadio

Slide Keeper for wardrobes



A	B	Finitura Finishing	Imballo Packaging	Cod.
555 - 710	448 - 609	Anodizzato opaco Matt anodized		1 UN/Ut. 7913362
710 - 855	603 - 758	Anodizzato opaco Matt anodized		1 UN/Ut. 7913462
855 - 1.000	748 - 893	Anodizzato opaco Matt anodized		1 UN/Ut. 7913562
1.000 - 1.150	893 - 1.043	Anodizzato opaco Matt anodized		1 UN/Ut. 7913662

Alluminio, Tecnoplastica  
Aluminium, Plastic

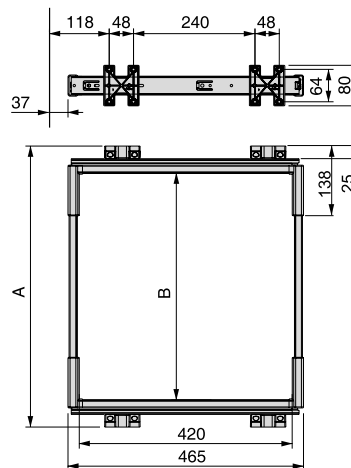

Set di distanziali per accessori estraibili Keeper

Set of spacers for removable Keeper

Finitura Finishing	Imballo Packaging	Cod.
Verniciato alluminio Silver painted		12 UN/Ut. 7914025

Tecnoplastica  
Plastic

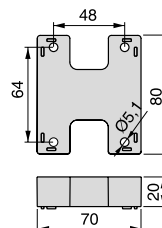

Da utilizzarsi con l'uso di ante con cerniera o scorrevoli che restano interne alla luce del mobile.

To be used with hinged doors or as a spacer for hollow modules.

**ACCESSORI KEEPER // KEEPER ACCESSORIES**

**Cassetti metallici Keeper per armadio**

**Metallic drawer Keeper for wardrobes**

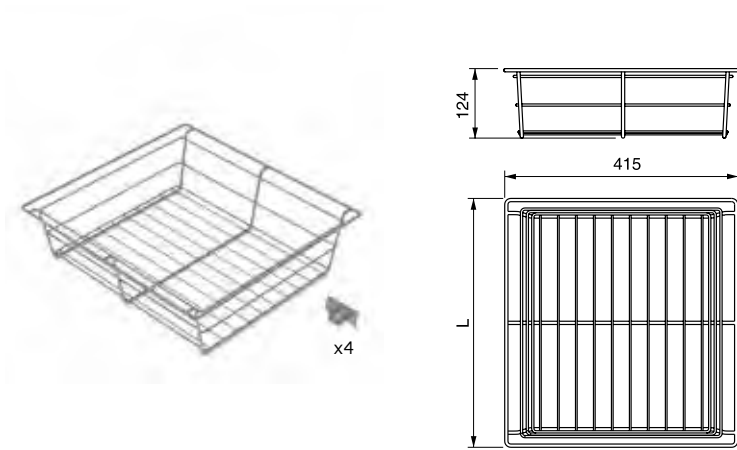

L	Finitura Finishing	Imballo Packaging	Cod.
443	Verniciato alluminio Silver painted	2 UN/Ut.	7913025
743	Verniciato alluminio Silver painted	2 UN/Ut.	7919425

Acciaio, Alluminio, Tecnoplastica  
Aluminium, Plastic, Steel

**Porta scarpe ausiliare Keeper per armadio**

**Auxiliary shoe rack Keeper for wardrobes**

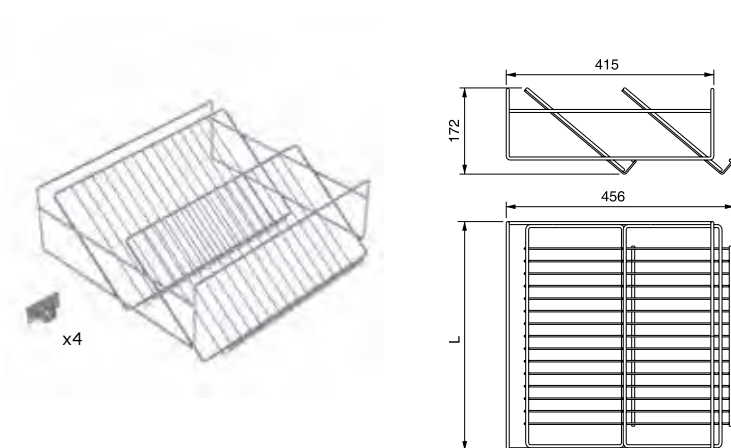

L	Finitura Finishing	Imballo Packaging	Cod.
458	Verniciato alluminio Silver painted	2 UN/Ut.	7914125
608	Verniciato alluminio Silver painted	2 UN/Ut.	7919525
758	Verniciato alluminio Silver painted	2 UN/Ut.	7919625

Acciaio  
Steel

**Cesto portabiancheria Keeper per armadio**

**Clothes basket Keeper for wardrobes**

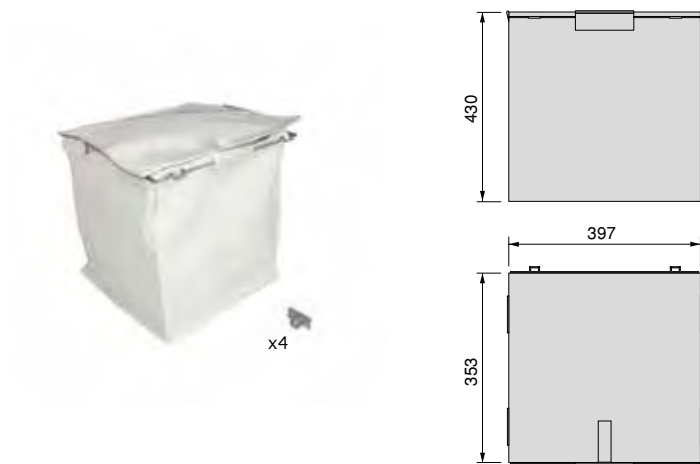

Finitura Finishing	Imballo Packaging	Cod.
Verniciato alluminio Silver painted	1 UN/Ut.	7914325

Acciaio, Vari  
Steel, Various







ACCESSORI KEEPER // KEEPER ACCESSORIES

Vaschetta Keeper per armadio

Tray Keeper for wardrobes

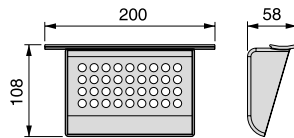

Finitura Finishing	Imballo Packaging	Cod.
Transparente / non classificata Transparent / not defined	2 UN/Ut.	7913220
Tecnoplastica Plastic		

Set di aste per porta pantaloni Keeper per armadio

Trouser hanging rack set Keeper for wardrobes



Finitura Finishing	Imballo Packaging	Cod.
Anodizzato opaco Matt anodized	1 UN/Ut.	7913162
Alluminio, Tecnoplastica Aluminium, Plastic		

Pinze appendiabiti Keeper per armadio

Hanging clip Keeper for wardrobes

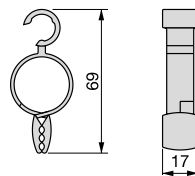

Finitura Finishing	Imballo Packaging	Cod.
Plastica grigia Grey plastic	10 UN/Ut.	6915321
Tecnoplastica Plastic		

Gancio per porta cravatte Keeper per armadio

Hook for tie rack Keeper for wardrobes

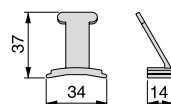

Finitura Finishing	Imballo Packaging	Cod.
Verniciato alluminio Silver painted	15 UN/Ut.	7914225
Tecnoplastica Plastic		



**ACCESSORI KEEPER // KEEPER ACCESSORIES**

**Porta scarpe laterale estraibile Keeper**

Keeper extractable lateral shoe rack

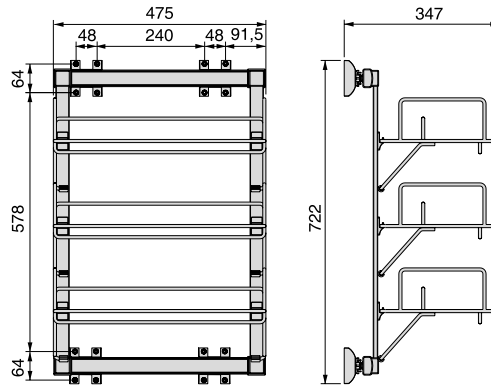

Finitura Finishing	Imballo Packaging	Cod.
Verniciato alluminio Silver painted	1 UN/Ut.	7913725
Acciaio, Tecnoplastica Plastic, Steel		

**Porta cravatte laterale estraibile Keeper per armadio**

Keeper extractable lateral tie rack for wardrobe

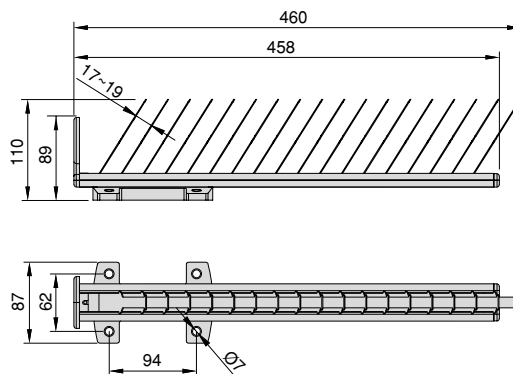

Finitura Finishing	Imballo Packaging	Cod.
Anodizzato opaco Matt anodized	1 UN/Ut.	7919962
Alluminio, Tecnoplastica Aluminium, Plastic		

**Porta cravatte laterale estraibile Keeper**

Keeper extractable lateral tie rack

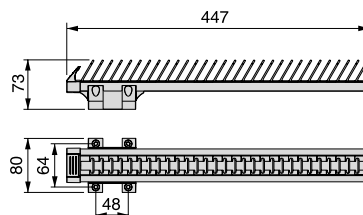

Finitura Finishing	Imballo Packaging	Cod.
Anodizzato opaco Matt anodized	1 UN/Ut.	7913862
Alluminio, Tecnoplastica Aluminium, Plastic		







**ACCESSORI KEEPER // KEEPER ACCESSORIES**

**Porta cinture laterale estraibile Keeper**

Keeper extractable lateral belt holder

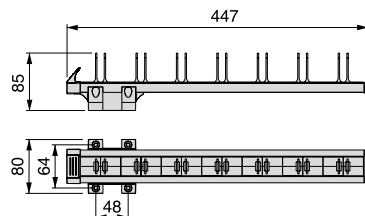

Finitura Finishing	Imballo Packaging	Cod.
Anodizzato opaco Matt anodized	1 UN/Ut.	7913962

Alluminio, Tecnoplastica  
Aluminium, Plastic

**Appendiabiti estraibile Keeper per armadio**

Keeper extractable hanger for wardrobe

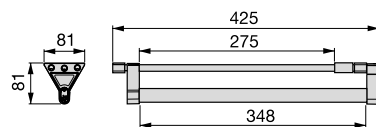

Lunghezza Longitude	Finitura Finishing	Imballo Packaging	Cod.
350	Anodizzato opaco Matt anodized	1 UN/Ut.	6916362

Alluminio  
Aluminium

**Appendiabiti estraibile Keeper per armadio**

Pull-out hanging rail for Keeper wardrobe

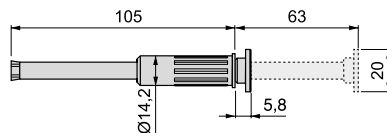

Finitura Finishing	Imballo Packaging	Cod.
Cromato brillo Chrome plated	1 UN/Ut.	7910611

Acciaio  
Steel

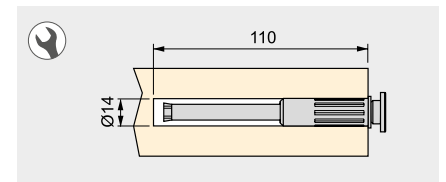

ACCESSORI MOKA // MOKA ACCESSORIES

Porta pantaloni estraibile

pull-out trouser rack

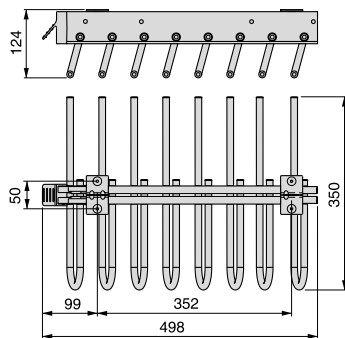

Lato Hand	Finitura Finishing	Imballo Packaging	Cod.
Sinistra Left	Verniciato moka Moka painted	1 UN/Ut.	6912813
Sinistra Left	Verniciato alluminio Silver painted	1 UN/Ut.	6912825
Destra Right	Verniciato moka Moka painted	1 UN/Ut.	6923413
Destra Right	Verniciato alluminio Silver painted	1 UN/Ut.	6923425

Acciaio, Tecnoplastica Plastic, Steel

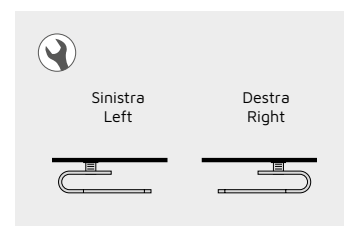

Specchio estraibile per interni di armadio.

Pull-out mirror for inside wardrobe.

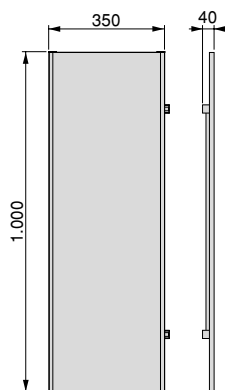

Finitura Finishing	Imballo Packaging	Cod.
Verniciato moka Moka painted	1 UN/Ut.	7018013
Verniciato alluminio Silver painted	1 UN/Ut.	7018025

Acciaio, Tecnoplastica, Vetro Glass, Plastic, Steel

Guide per specchio estraibile

Slides for a lateral pull-out mirror

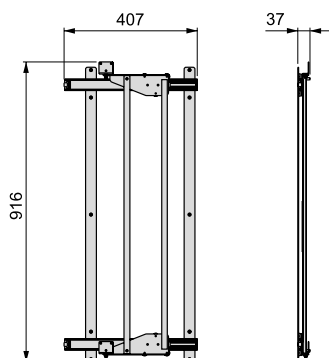

Finitura Finishing	Imballo Packaging	Cod.
Verniciato alluminio Silver painted	1 UN/Ut.	7010625

Acciaio Steel



Estrazione dello specchio mediante guide a sfera.  
 Profondità minima del modulo 410mm.  
 Completo di viti per il montaggio.  
 Specchio escluso.

Extraction with ball bearing runners.  
 Minimum depth of cabinet 410mm.  
 Supplied with screws to be mounted.  
 Mirror not included.







ACCESSORI SELF // SELF ACCESSORIES

Porta pantaloni Self montaggio laterale per armadio

Wardrobe side mounting Self trouser rack

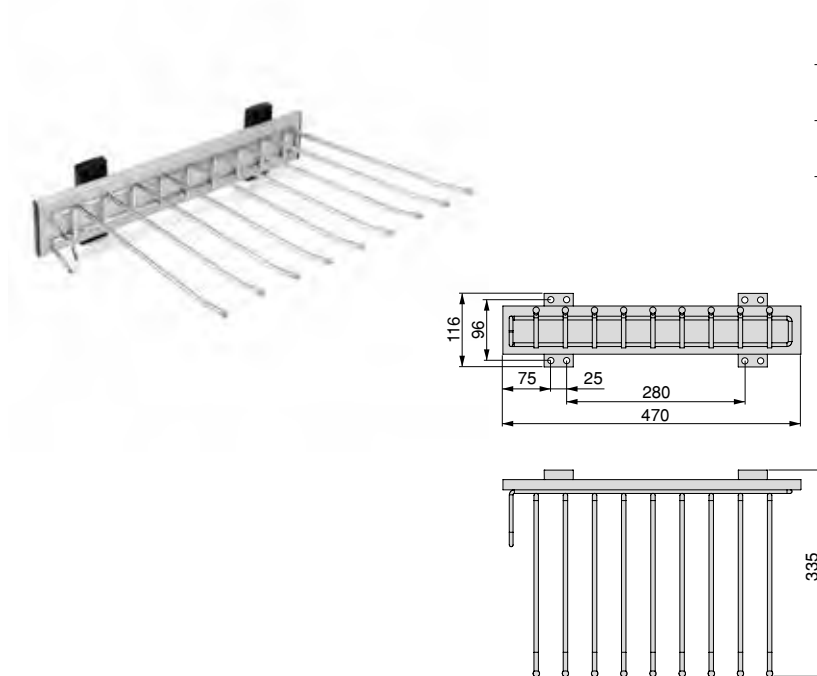

Lato Hand	Finitura Finishing	Imballo Packaging	Cod.
Mano sinistra Left hand	Cromato brillo Chrome plated	1 UN/Ut.	7018111
Mano destra Right hand	Cromato brillo Chrome plated	1 UN/Ut.	7018211

Acciaio, Alluminio, Tecnoplastica  
Aluminium, Plastic, Steel

Porta pantaloni doppio estraibile per armadio.

Self Pullout double trouser rack for wardrobes.

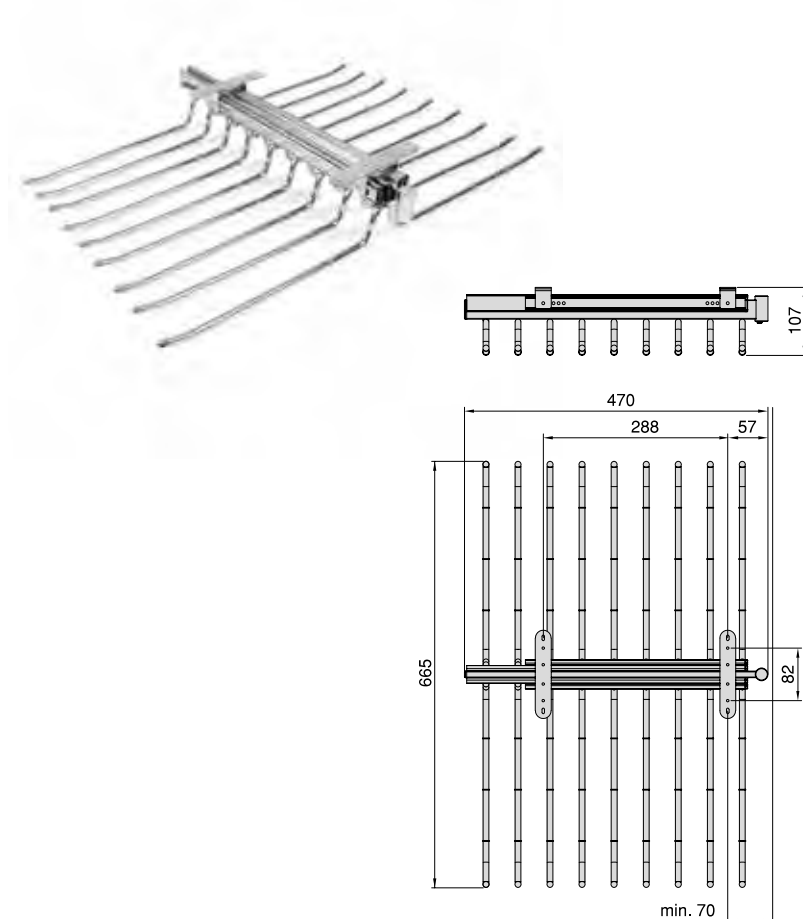

Finitura Finishing	Imballo Packaging	Cod.
Cromato brillo Chrome plated	1 UN/Ut.	7017911

Acciaio, Tecnoplastica  
Plastic, Steel

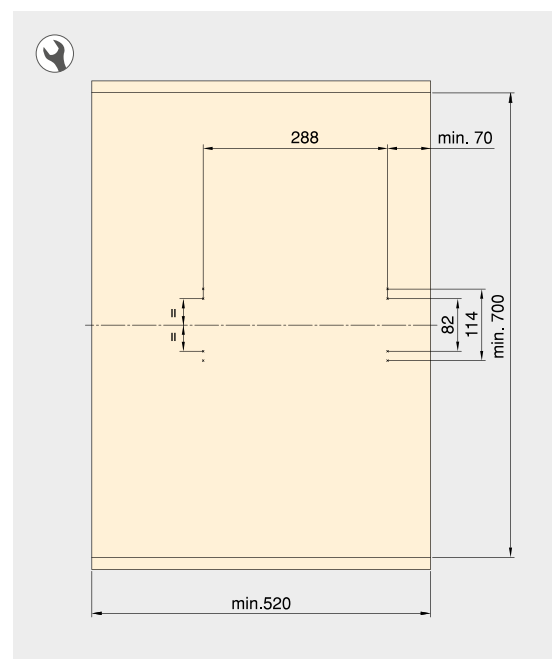

ACCESSORI SELF // SELF ACCESSORIES

Porta pantaloni estraibile Self

Self pull-out trouser rack



Finitura Finishing	Imballo Packaging	Cod.
Cromato brillo Chrome plated	1 UN/Ut.	7017811

Acciaio Steel

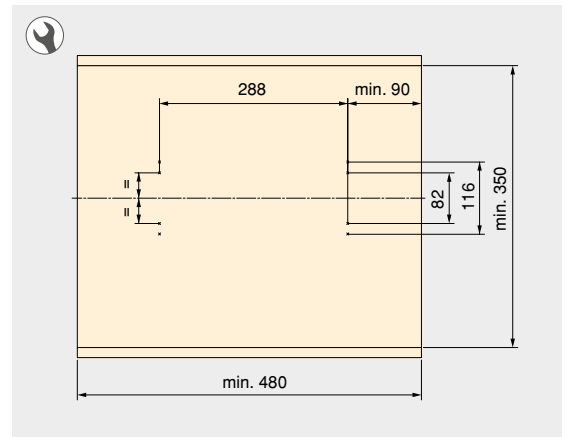
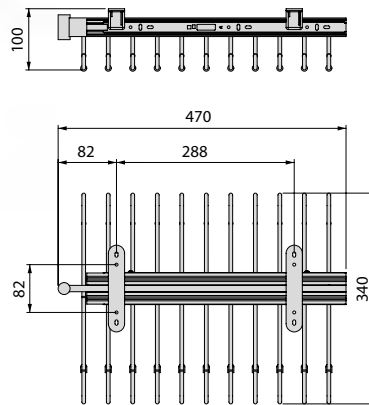

Porta pantaloni laterale estraibile Self

Self pull-out lateral trouser rack

Finitura Finishing	Imballo Packaging	Cod.
Verniciato alluminio Silver painted	1 UN/Ut.	6211125

Acciaio, Tecnoplastica Plastic, Steel

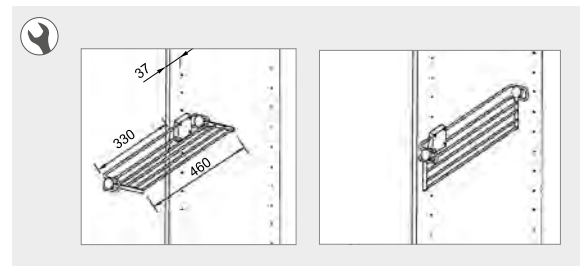
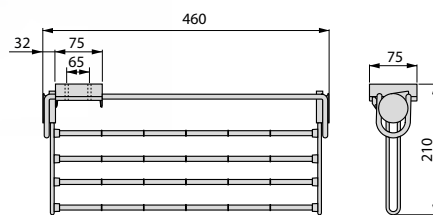

Porta scarpe Self per interno armadio

Self shoe rack for inside wardrobe

Finitura Finishing	Imballo Packaging	Cod.
Verniciato alluminio Silver painted	1 UN/Ut.	6211125

Acciaio, Tecnoplastica Plastic, Steel

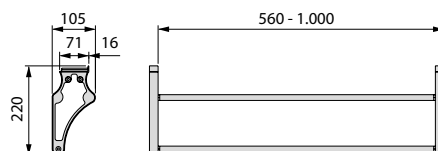





**ACCESSORI SELF // SELF ACCESSORIES**

**Appendiabiti estraibile Self per armadio**

Self Pull-out wardrobe rail



A	B	L	Finitura Finishing	Imballo Packaging	Cod.
335	302	300	Verniciato alluminio Silver painted	10 UN/Ut.	6210925
385	352	350	Verniciato alluminio Silver painted	10 UN/Ut.	6210825
435	402	400	Verniciato alluminio Silver painted	10 UN/Ut.	6210725
485	452	450	Verniciato alluminio Silver painted	10 UN/Ut.	6210625

Acciaio, Tecnoplastica Plastic, Steel

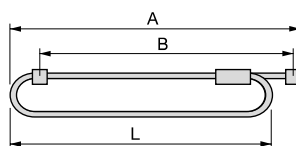

**Appendiabiti estraibile per armadi a grande profondità Self**

Self extractable hanger for very deep wardrobes



Lunghezza Longitude	Finitura Finishing	Imballo Packaging	Cod.
800	Verniciato alluminio Silver painted	1 UN/Ut.	7005725

Acciaio, Tecnoplastica Plastic, Steel

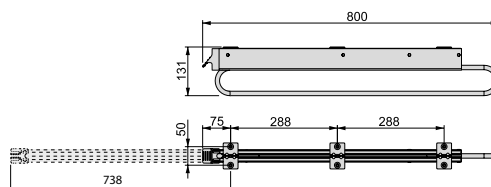

**Porta cravatte laterale estraibile Self**

Self pull-out lateral tie

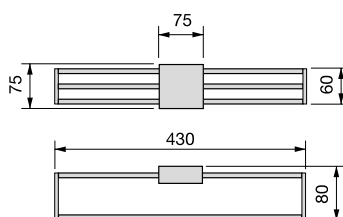

Finitura Finishing	Imballo Packaging	Cod.
Verniciato alluminio Silver painted	10 UN/Ut.	6211025

Acciaio, Tecnoplastica Plastic, Steel





“

PROFILI



PROFILES

”

PROFILI MANIGLIA-RADDRIZZA-ANTE ADIGE // ADIGE HANDLE PROFILES

Profilo verticale Adige per armadio

Adige vertical profile for wardrobe

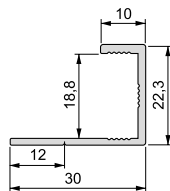

Lunghezza Longitude	Finitura Finishing	Imballo Packaging	Cod.
2,8 m	Anodizzato opaco Matt anodized	10 UN/Ut.	7013462

Alluminio  
Aluminium

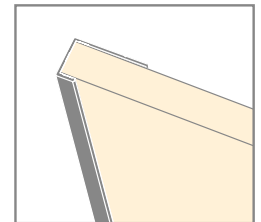

Profilo maniglia Adige per armadio

Adige handle profile for wardrobe

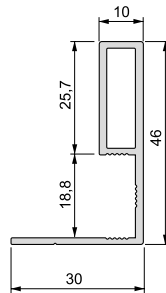

Lunghezza Longitude	Finitura Finishing	Imballo Packaging	Cod.
2,8 m	Anodizzato opaco Matt anodized	10 UN/Ut.	7013262

Alluminio  
Aluminium

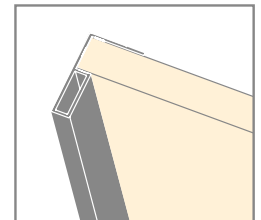

Profilo maniglia-spalla Adige per armadio

Adige handle cover profile for wardrobe

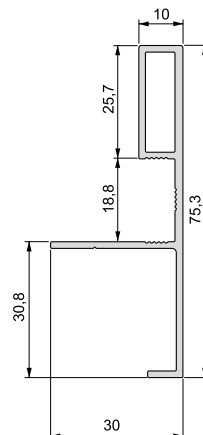

Lunghezza Longitude	Finitura Finishing	Imballo Packaging	Cod.
2,8 m	Anodizzato opaco Matt anodized	10 UN/Ut.	7013362

Alluminio  
Aluminium

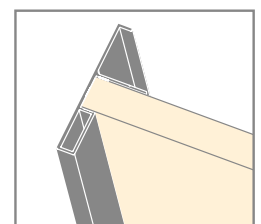

Per calcolare la misura di taglio del pannello togliere 4 mm alla larghezza della anta.

To calculate the measure to cut the board reduce 4 mm to the width of door.



Possibilità di personalizzare su misura.  
Can be cut to size.



PROFILI MANIGLIA-RADDRIZZA-ANTE FREE FACE // FREE FACE HANDLE PROFILES

Profilo verticale Free Face per armadio

Free Face vertical profile for wardrobe

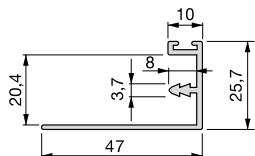

Lunghezza Longitude	Finitura Finishing	Imballo Packaging	Cod.
2,35 m	Anodizzato opaco Matt anodized	10 UN/Ut.	7025562
2,9 m	Anodizzato opaco Matt anodized	10 UN/Ut.	5872762

Alluminio Aluminium

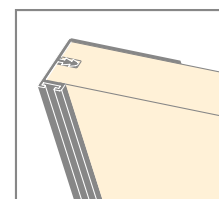

Profilo maniglia Free Face per armadio

Free Face handle profile for wardrobe

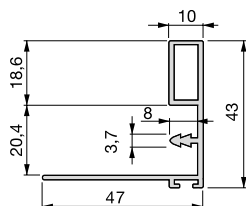

Lunghezza Longitude	Finitura Finishing	Imballo Packaging	Cod.
2,35 m	Anodizzato opaco Matt anodized	10 UN/Ut.	7025362
2,9 m	Anodizzato opaco Matt anodized	10 UN/Ut.	5872862

Alluminio Aluminium

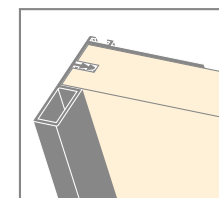

Profilo maniglia-spalla Free Face per armadio

Free Face handle cover profile for wardrobe

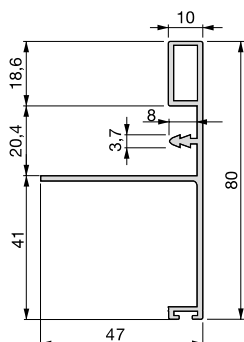

Lunghezza Longitude	Finitura Finishing	Imballo Packaging	Cod.
2,35 m	Anodizzato opaco Matt anodized	5 UN/Ut.	7025462
2,9 m	Anodizzato opaco Matt anodized	5 UN/Ut.	5872962

Alluminio Aluminium

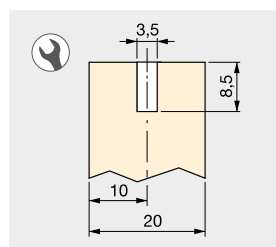
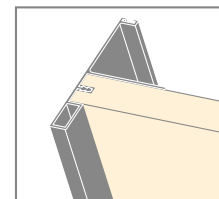

Per calcolare la misura di taglio del pannello togliere 4 mm alla larghezza della anta. Permette l'utilizzo dei profili parapolvere Cod. 9045121, 9034221 e 9034121.

To calculate the measure to cut the board reduce 4 mm to the width of door. Allows the use of dustguards profiles Cod. 9045121, 9034221 and 9034121.



Possibilità di personalizzare su misura. Can be cut to size.

PROFILI MANIGLIA-RADDRIZZA-ANTE FREE RAPID // FREE RAPID HANDLE PROFILES

Profilo verticale Free Rapid per armadio

Free Rapid vertical profile for wardrobe

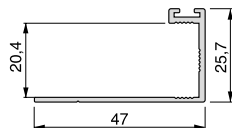

Lunghezza Longitude	Finitura Finishing	Imballo Packaging	Cod.
2,35 m	Anodizzato opaco Matt anodized	10 UN/Ut.	7026062
2,7 m	Anodizzato opaco Matt anodized	10 UN/Ut.	7018562

Alluminio  
Aluminium

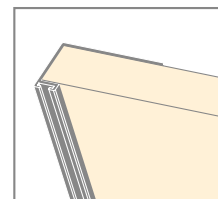

Profilo maniglia Free Rapid per armadio

Free Rapid handle profile for wardrobe

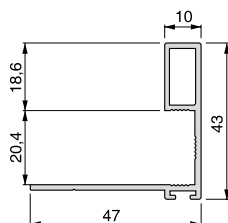

Lunghezza Longitude	Finitura Finishing	Imballo Packaging	Cod.
2,35 m	Anodizzato opaco Matt anodized	10 UN/Ut.	7025862
2,7 m	Anodizzato opaco Matt anodized	10 UN/Ut.	7018362

Alluminio  
Aluminium

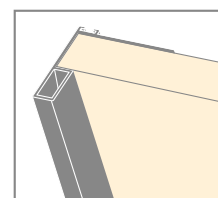

Profilo maniglia-spalla Free Rapid

Free Rapid handle cover profile

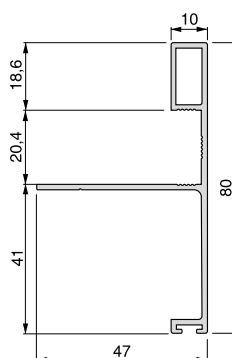

Lunghezza Longitude	Finitura Finishing	Imballo Packaging	Cod.
2,35 m	Anodizzato opaco Matt anodized	5 UN/Ut.	7025962
2,7 m	Anodizzato opaco Matt anodized	5 UN/Ut.	7018462

Alluminio  
Aluminium

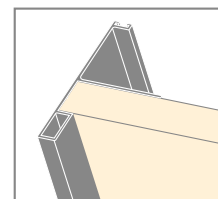

Per calcolare la misura di taglio del pannello togliere 4 mm alla larghezza della anta. Permette l'utilizzo dei profili parapolvere Cod. 9045121, 9034221 e 9034121.

To calculate the measure to cut the board reduce 4 mm to the width of door. Allows the use of dustguards profiles Cod. 9045121, 9034221 and 9034121.



Possibilità di personalizzare su misura.  
Can be cut to size.

PROFILI MANIGLIA-RADDRIZZA-ANTE STYL // STYL HANDLE PROFILES

Profilo maniglia Styl 1 per armadio

Styl 1 handle profile for wardrobe

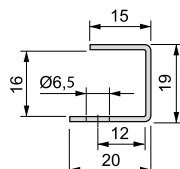

Lunghezza Longitude	Finitura Finishing	Imballo Packaging	Cod.
2,355 m	Verniciato alluminio Silver painted	 10 UN/Ut.	7016125

Acciaio  
Steel

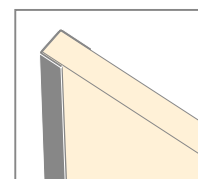

Per calcolare la misura di taglio del pannello togliere 2 mm alla larghezza della anta.

To calculate the measure to cut the board reduce 2 mm to the width of door.

Profili maniglia-raddrizza-ante U Styl 1 per armadio

U Styl 1 handle profiles for wardrobe

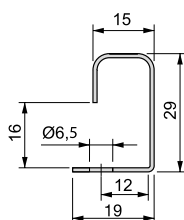

Lunghezza Longitude	Finitura Finishing	Imballo Packaging	Cod.
2,355 m	Verniciato alluminio Silver painted	 10 UN/Ut.	7016325

Acciaio  
Steel

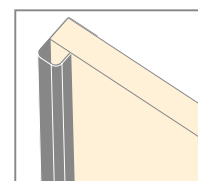

Per calcolare la misura di taglio del pannello togliere 2 mm alla larghezza della anta.

To calculate the measure to cut the board reduce 2 mm to the width of door.



Possibilità di personalizzare su misura.  
Can be cut to size.

PROFILI MANIGLIA-RADDRIZZA-ANTE RHODES // RHODES HANDLE PROFILES

Maniglia per mobili Rhodes

Rhodes furniture handle

Lunghezza Longitude	Finitura Finishing	Imballo Packaging	Cod.
2,9 m	Anodizzato opaco Matt anodized	10 UN/Ut.	9296662

Alluminio  
Aluminium

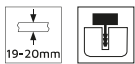
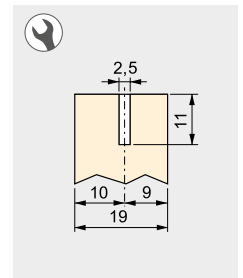
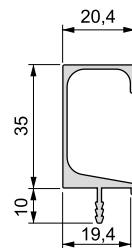



PROFILI MANIGLIA-RADDRIZZA-ANTE SPARTA // SPARTA HANDLE PROFILES

Maniglia per mobili Profilo Sparta

Sparta profile furniture handle

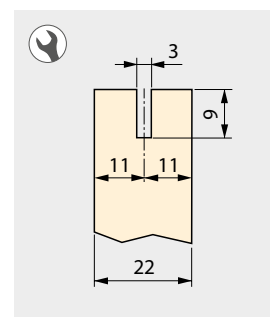
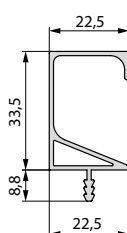
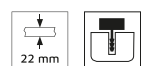

Lunghezza Longitude	Finitura Finishing	Imballo Packaging	Cod.
2,35 m	Anodizzato opaco Matt anodized	10 UN/Ut.	7026562

Alluminio  
Aluminium

Tappi chiusura Sparta per maniglia di armadio

Sparta covers for cabinet handles

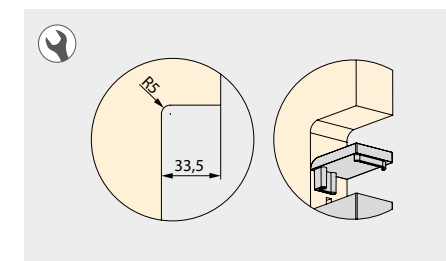
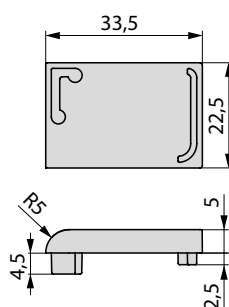

Finitura Finishing	Imballo Packaging	Cod.
Verniciato alluminio Silver painted	10 UN/Ut.	9291125

Tecnoplastica  
Plastic



Possibilità di personalizzare su misura.  
Can be cut to size.

PARAPOLVERE PER PORTE SCORREVOLI // DUST EXCLUDER STRIPS

Parapolvere senza adesivo per porte scorrevoli

Profiles without adhesive dust cover for sliding door

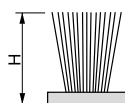

Altezza Height	Lunghezza Longitude	Finitura Finishing	Imballo Packaging	Cod.
5	375 m	Plastica grigia Grey plastic	1 UN/Ut.	9045121
7	225 m	Plastica grigia Grey plastic	1 UN/Ut.	9034221
9	175 m	Plastica grigia Grey plastic	1 UN/Ut.	9034121

Tecnoplastica Plastic

Parapolvere con adesivo per porte scorrevoli

Profiles with adhesive dust cover for sliding door

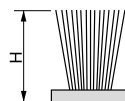

Altezza Height	Lunghezza Longitude	Finitura Finishing	Imballo Packaging	Cod.
7	400 m	Plastica grigia Grey plastic	1 UN/Ut.	9129921
9	300 m	Plastica grigia Grey plastic	1 UN/Ut.	9034321
17	125 m	Plastica grigia Grey plastic	1 UN/Ut.	9054021

Tecnoplastica Plastic

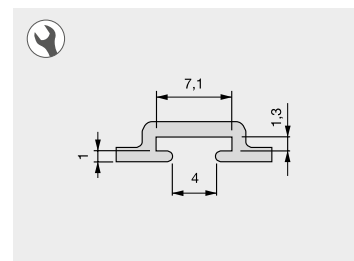

PROFILI PER PORTE FACE // EDGING PROFILES FACE

Profili per ante Face 2

Profile for edges Face 2



Spessore pannello Board thickness	Lunghezza Longitude	Finitura Finishing	Imballo Packaging	Cod.
19	2,35 m	Anodizzato opaco Matt anodized	 25 UN/Ut.	6224362

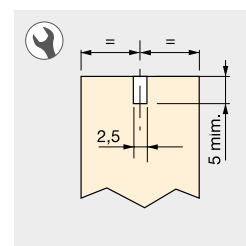
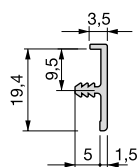

Alluminio  
Aluminium



Profili per ante Face 3

Profile for edges Face 3



A	B	Spessore pannello Board thickness	Lunghezza Longitude	Finitura Finishing	Imballo Packaging	Cod.
16.4	8	16	3.2 m	Anodizzato opaco Matt anodized	 25 UN/Ut.	6225162
19.4	9.5	19	2,35 m	Anodizzato opaco Matt anodized	 25 UN/Ut.	6224462

Alluminio  
Aluminium

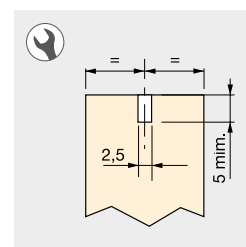
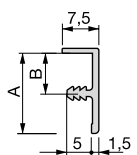

Profili per ante Face 4

Profile for edges Face 4



Spessore pannello Board thickness	Lunghezza Longitude	Finitura Finishing	Imballo Packaging	Cod.
19	2,35 m	Anodizzato opaco Matt anodized	 25 UN/Ut.	7025662

Alluminio  
Aluminium

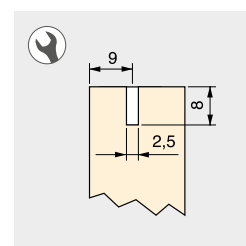
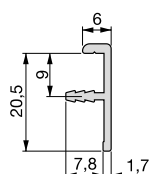

Possibilità di personalizzare su misura.  
Can be cut to size.

PROFILI PER PORTE FACE // EDGING PROFILES FACE

Profili per ante Face H

Profile for edges Face H

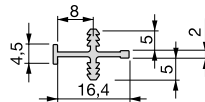

Lunghezza Longitude	Finitura Finishing	Imballo Packaging	Cod.
2,35 m	Anodizzato opaco Matt anodized	20 UN/Ut.	7025762

Alluminio Aluminium

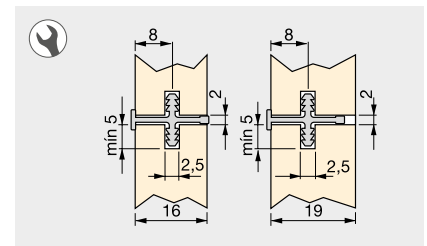

Profili per ante Face T

Profile for edges Face T



Lunghezza Longitude	Finitura Finishing	Imballo Packaging	Cod.
2,35 m	Anodizzato opaco Matt anodized	25 UN/Ut.	6057762

Alluminio Aluminium

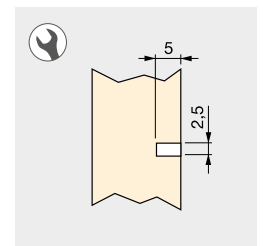

Profili per ante Wind

Profile for edges Wind

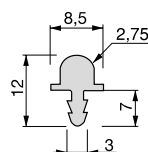

Lunghezza Longitude	Finitura Finishing	Imballo Packaging	Cod.
2,35 m	Alluminio naturale Natural aluminium	20 UN/Ut.	6301761

Alluminio Aluminium

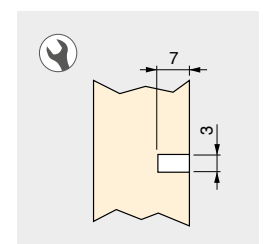

Possibilità di personalizzare su misura.  
Can be cut to size.



RADDRIZZA ANTE // DOOR TRUSS

Raddrizza ante Even per porte scorrevoli

Even truss for wardrobe door



L	M	Finitura Finishing	Imballo Packaging	Cod.
1.970	1.920	Anodizzato opaco Matt anodized	25 UN/Ut.	7089662
2.290	2.240	Anodizzato opaco Matt anodized	25 UN/Ut.	7089762

Acciaio, Alluminio, Tecnoplastica  
Aluminium, Plastic, Steel

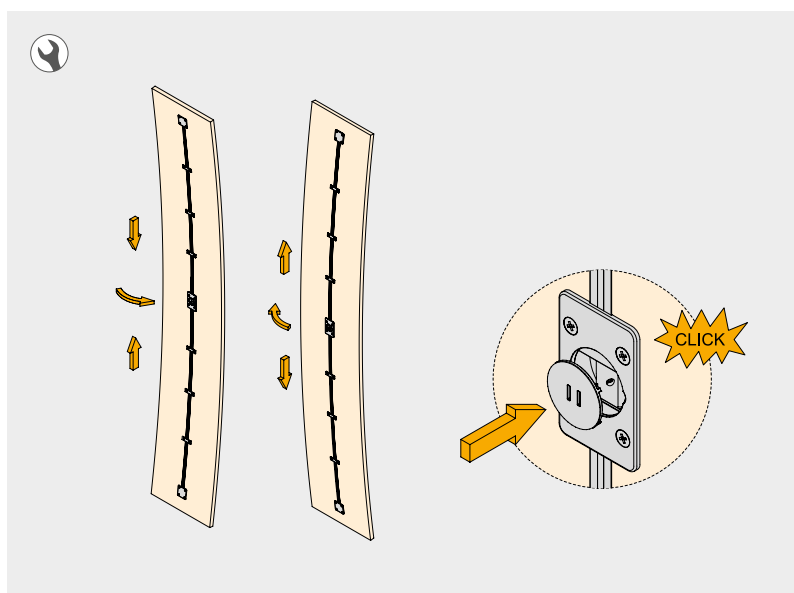
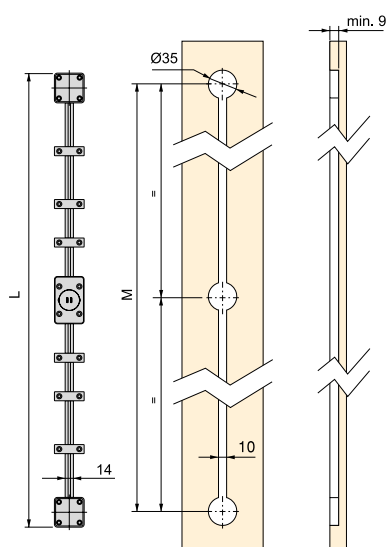

Si raccomanda l'utilizzo di 2 raddrizzante per ogni ante.

For the assembly, we recommend to use 2 truss per door.





“ STRUTTURE MODULARI

MODULAR SHELVING ”

STRUTTURA MODULARE ZERO IN FORMATO KIT // MODULAR STRUCTURE ZERO IN KIT FORM

Kit struttura modulare Zero con raccordi e profili per montaggio a L

Zero modular structure kit with tools and profiles to be assembled in L-shape



Descrizioni Description	Finitura Finishing	Imballo Packaging	Cod.
2 Profili 2 Profiles	Nero testurizzato Textured black painted	1 UN/Ut.	7022054
3 Profili 3 Profiles	Nero testurizzato Textured black painted	1 UN/Ut.	7022154

Alluminio, Tecnoplastica, Zama  
Aluminium, Plastic, Zamak

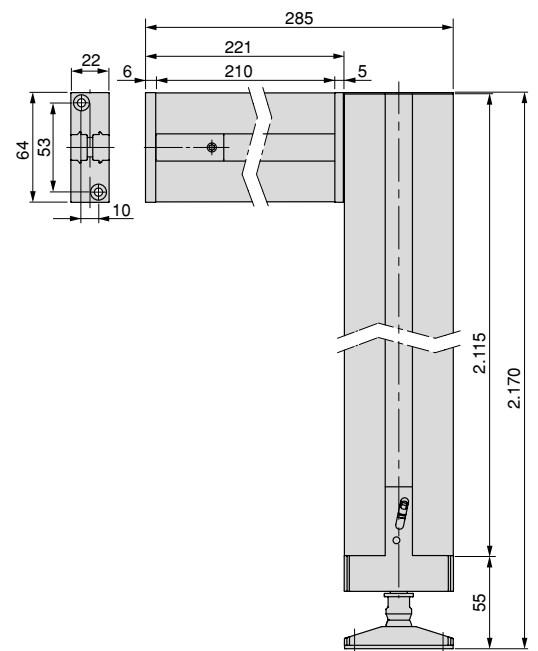
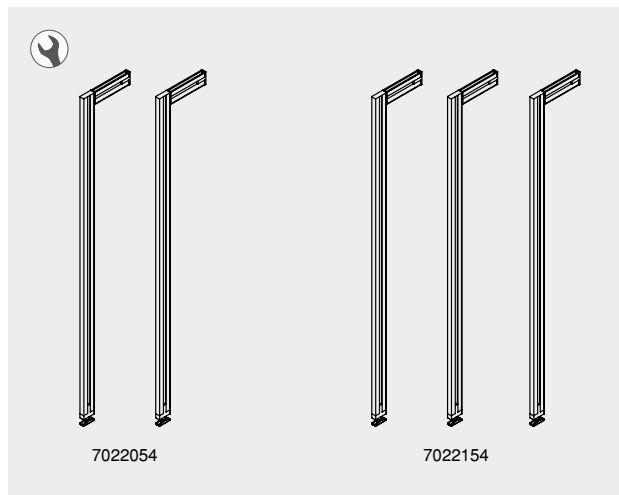

Kit Zero di supporti per mensole in legno e moduli

Zero support kit for wooden shelves and module

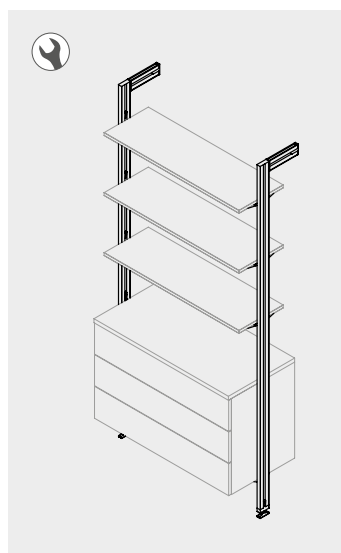

Finitura Finishing	Imballo Packaging	Cod.
Nero testurizzato Textured black painted	1 UN/Ut.	7022254

Tecnoplastica, Zama  
Plastic, Zamak





STRUTTURA MODULARE ZERO IN FORMATO KIT // MODULAR STRUCTURE ZERO IN KIT FORM

Kit Zero di supporti per mensole in legno e barra appendiabiti

Zero Kit supports for wooden shelves and hanging rail

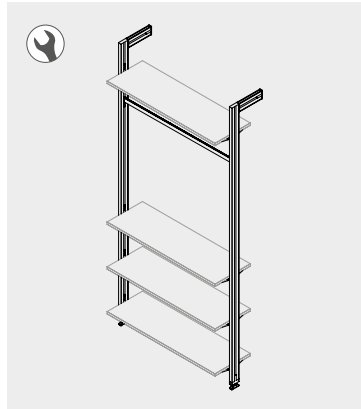

Finitura Finishing	Imballo Packaging	Cod.
Nero testurizzato Textured black painted	1 UN/Ut.	7022354

Alluminio, Tecnoplastica, Zama  
Aluminium, Plastic, Zamak

Kit Zero di supporti per mensole in legno, modulo e barra appendiabiti

Zero support kit for wooden and module shelves and hanging rail

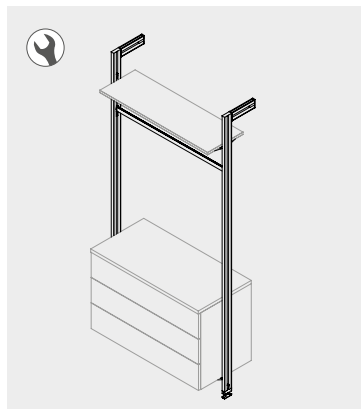

Finitura Finishing	Imballo Packaging	Cod.
Nero testurizzato Textured black painted	1 UN/Ut.	7022454

Alluminio, Tecnoplastica, Zama  
Aluminium, Plastic, Zamak

Set staffe Zero per mensola in legno

Zero support set for wooden shelf



Finitura Finishing	Imballo Packaging	Cod.
Nero testurizzato Textured black painted	1 UN/Ut.	7021354

Zama  
Zamak

Set staffe Zero per mensola in vetro

Zero support set for glass shelf



Finitura Finishing	Imballo Packaging	Cod.
Nero testurizzato Textured black painted	1 UN/Ut.	7021454

Zama  
Zamak

**STRUTTURA MODULARE ZERO // MODULAR STRUCTURE ZERO**

**Profilo per realizzare strutture modulari Zero**

Profile for Zero modular structures



Lunghezza Longitude	Finitura Finishing	Imballo Packaging	Cod.
2,35 m	Nero testurizzato Textured black painted	8 UN/Ut.	7020154
2,9 m	Nero testurizzato Textured black painted	8 UN/Ut.	7020254

Alluminio  
Aluminium

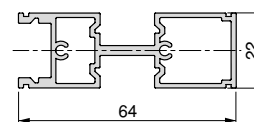

Possibilità di personalizzare su misura.  
Can be cut to size.

**Set ferramenta per il montaggio di profili Zero a L**

tool assembly set for assembling Zero profiles in L-shape



Finitura Finishing	Imballo Packaging	Cod.
Nero testurizzato Textured black painted	1 UN/Ut.	7021054

Tecnoplastica, Zama  
Plastic, Zamak

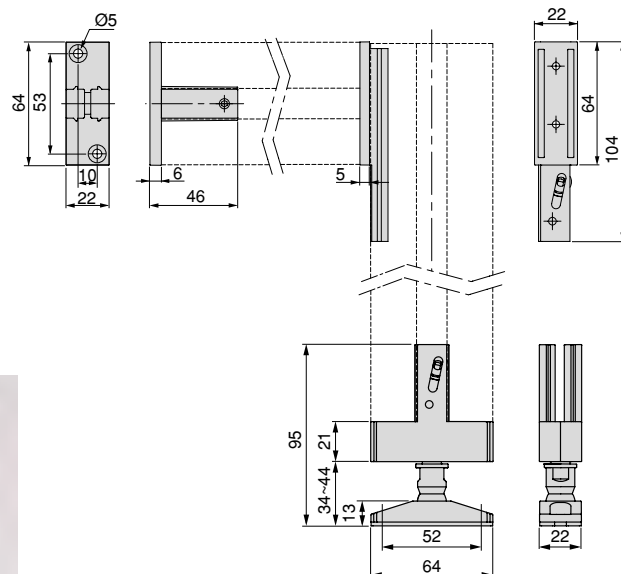







**STRUTTURA MODULARE ZERO // MODULAR STRUCTURE ZERO**

**Pezzi per il fissaggio del profilo Zero a parete**

piece to affix the Zero profile to the wall



Finitura Finishing	Imballo Packaging	Cod.
Nero testurizzato Textured black painted	1 UN/Ut.	7021754

Zama  
Zamak

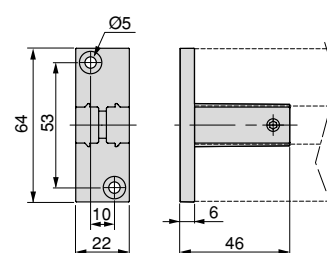

**Pezzo di giunzione tra i profili Zero**

Joint between Zero profiles



Finitura Finishing	Imballo Packaging	Cod.
Nero testurizzato Textured black painted	1 UN/Ut.	7021254

Zama  
Zamak

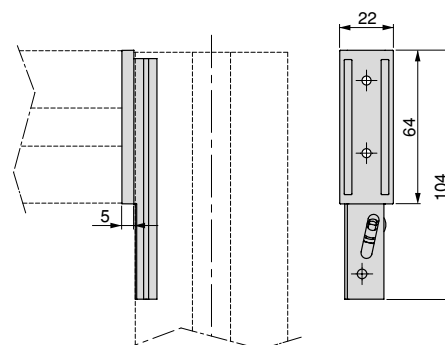



STRUTTURA MODULARE ZERO // MODULAR STRUCTURE ZERO

Livellatore di fissaggio a pavimento / soffitto per profilo Zero

Leveller to affix profile to floor/ceiling for Zero profile



Finitura Finishing	Imballo Packaging	Cod.
Nero testurizzato Textured black painted	1 UN/Ut.	7021154

Tecnoplastica, Zama  
Plastic, Zamak

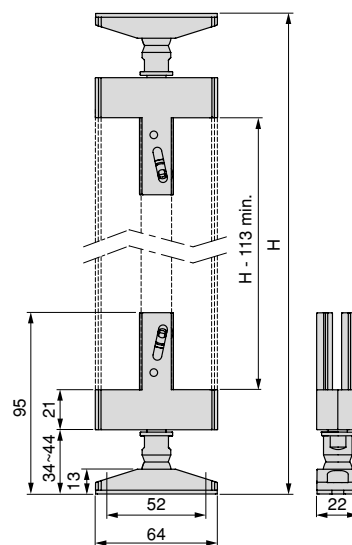

Set staffe Zero per mensola in legno

Zero support set for wooden shelf



Finitura Finishing	Imballo Packaging	Cod.
Nero testurizzato Textured black painted	1 UN/Ut.	7021354

Zama  
Zamak

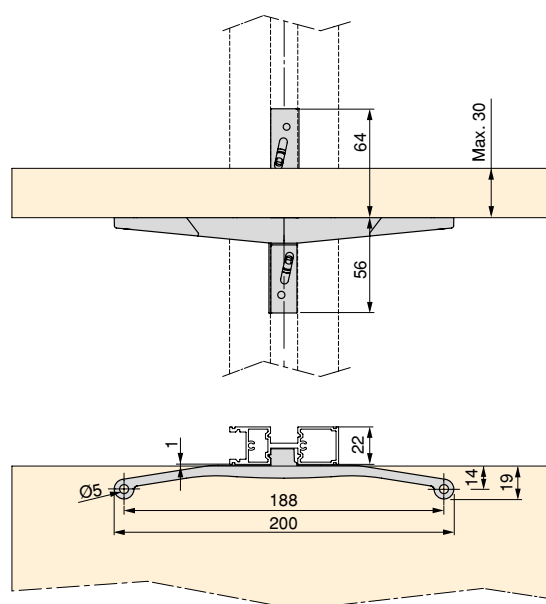



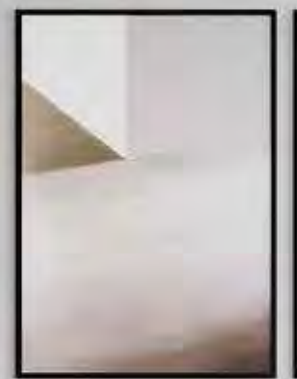

STRUTTURA MODULARE ZERO // MODULAR STRUCTURE ZERO

Set staffe Zero per mensola in vetro

Zero support set for glass shelf



Finitura Finishing	Imballo Packaging	Cod.
Nero testurizzato Textured black painted	1 UN/Ut.	7021454

Zama  
Zamak

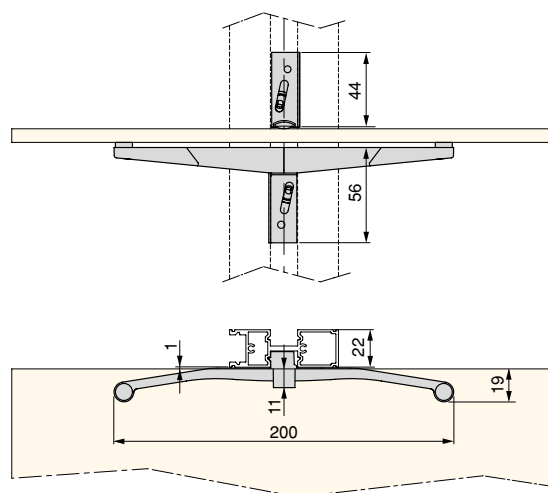

Set staffe Zero per modulo

Zero support kit for module



Finitura Finishing	Imballo Packaging	Cod.
Nero testurizzato Textured black painted	1 UN/Ut.	7021554

Zama  
Zamak

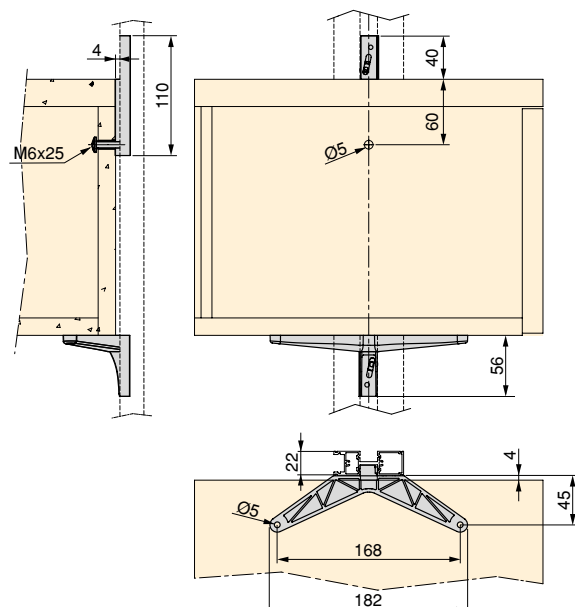





STRUTTURA MODULARE ZERO // MODULAR STRUCTURE ZERO

Set staffe Zero per tubo sospeso

Zero support kit for hanging rail

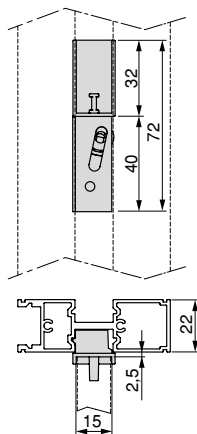

Finitura Finishing	Imballo Packaging	Cod.
Nero testurizzato Textured black painted	1 UN/Ut.	7021654

Tecnoplastica, Zama  
Plastic, Zamak

Barra rettangolare Luxe per struttura Zero

Luxe rectangular rail for Zero structure

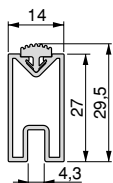

Lunghezza Longitude	Finitura Finishing	Imballo Packaging	Cod.
1 m	Nero testurizzato Textured black painted	10 UN/Ut.	7102154
2,35 m	Nero testurizzato Textured black painted	10 UN/Ut.	7102254

Alluminio  
Aluminium



Possibilità di personalizzare su misura.  
Can be cut to size.

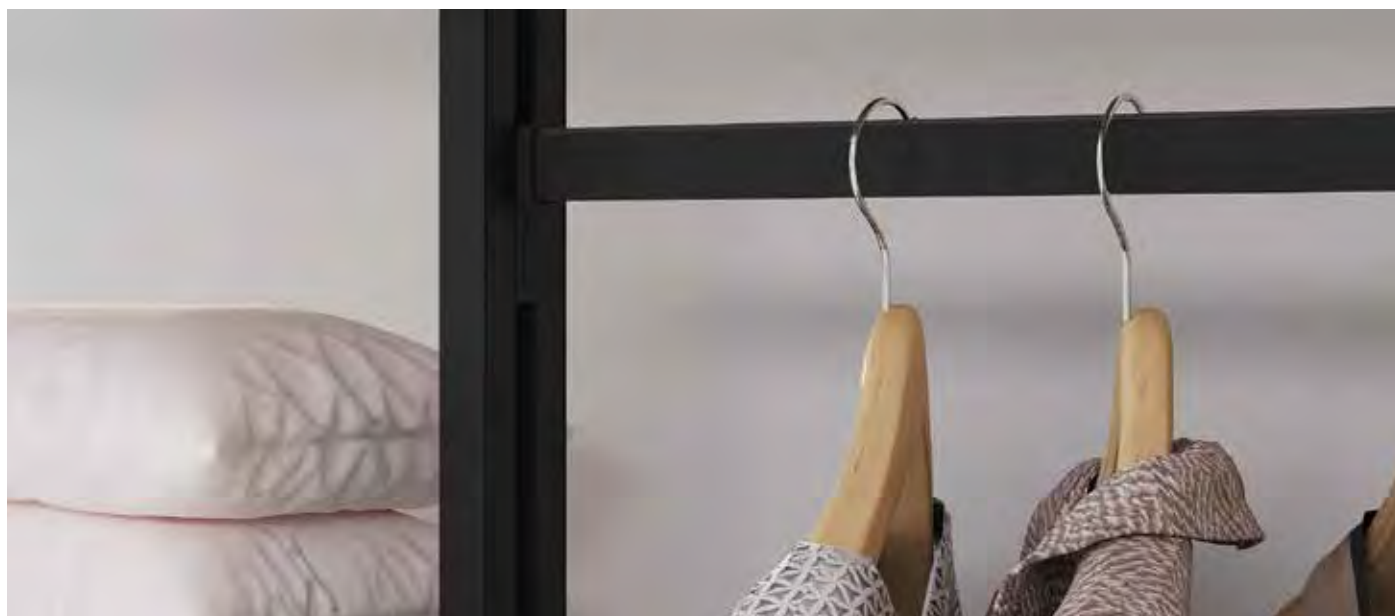







SCAFFALE LADER // LADER BOOKCASES

Struttura per Scaffale Lader

Structure for Lader bookcases



Altezza Height	Finitura Finishing	Imballo Packaging	Cod.
830	Verniciato nero Black painted	1 UN/Ut.	4450014
1150	Verniciato nero Black painted	1 UN/Ut.	4450114
1790	Verniciato nero Black painted	1 UN/Ut.	4450314

Acciaio Steel

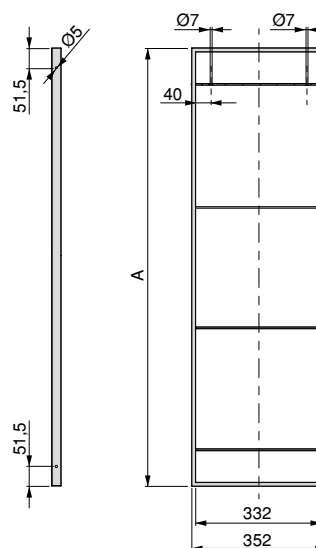

Scaffale Lader con struttura e ripiani

Lader Bookcases with structure and shelves



Larghezza Width	Altezza Height	Finitura Finishing	Imballo Packaging	Cod.
690	1150	Verniciato nero Black painted	1 UN/Ut.	4450214

Acciaio, Legno Steel, Wood

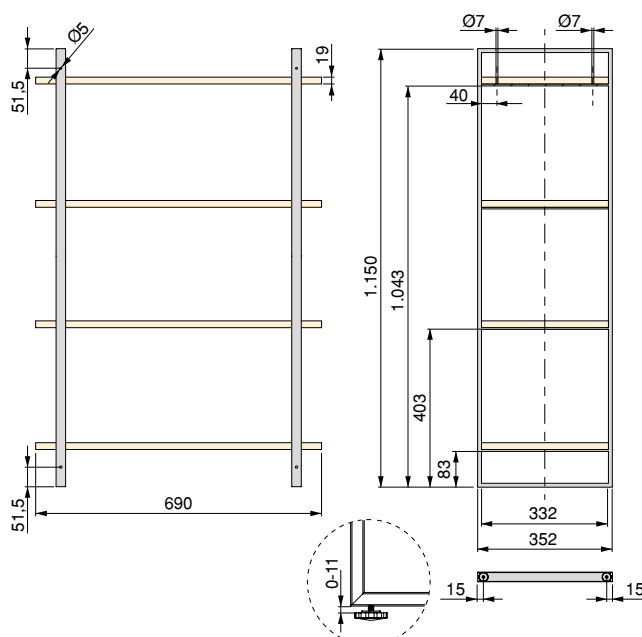



**STRUTTURA JAGMET // JAGMET STRUCTURE**

**Profilo Jagmet cremagliera semplice passo 50 mm**

Profile Jagmet simple step 50 mm slot



Lunghezza Longitude	Finitura Finishing	Imballo Packaging	Cod.
1 m	Verniciato bianco White painted	10 UN/Ut.	7918012
2,0 m	Verniciato bianco White painted	10 UN/Ut.	7916512
2,5 m	Verniciato bianco White painted	10 UN/Ut.	7916612

Acciaio Steel

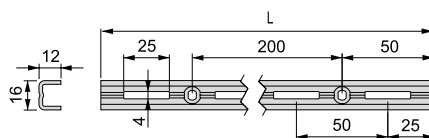

**Supporto ripiano per armadio Jagmet profilo passo 50 mm**

Jagmet shelf support for profiles with 50 mm gap



Portata Load	Lunghezza Longitude	Finitura Finishing	Imballo Packaging	Cod.
40	200	Verniciato bianco White painted	20 UN/Ut.	7917012
32	250	Verniciato bianco White painted	20 UN/Ut.	7915612
26	300	Verniciato bianco White painted	20 UN/Ut.	7915712
23	350	Verniciato bianco White painted	20 UN/Ut.	7915812
20	400	Verniciato bianco White painted	20 UN/Ut.	7915912

Acciaio Steel

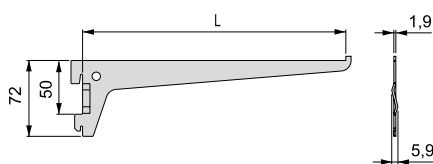

STRUTTURA JAGMET // JAGMET STRUCTURE

Profilo Jagmet cremagliera doppia passo 32 mm

Profile Jagmet 32 mm slot-pitch



Lunghezza Longitude	Finitura Finishing	Imballo Packaging	Cod.
0,951 m	Verniciato bianco White painted	10 UN/Ut.	7916712
1,396 m	Verniciato bianco White painted	10 UN/Ut.	7916812
2,064 m	Verniciato bianco White painted	10 UN/Ut.	7916912
2,229 m	Verniciato bianco White painted	10 UN/Ut.	7917912

Acciaio  
Steel

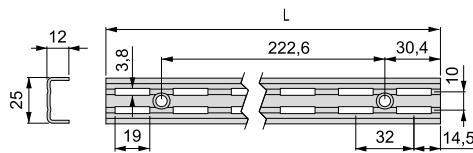

Reggipiano Jagmet cremagliera doppio passo 32 mm

Jagmet shelf support for profiles with 32 mm gap



Altezza Height	Portata Load	Lunghezza Longitude	Finitura Finishing	Imballo Packaging	Cod.
47	44	170	Verniciato bianco White painted	20 UN/Ut.	7916012
49	34	220	Verniciato bianco White painted	20 UN/Ut.	7916112
52	27	270	Verniciato bianco White painted	20 UN/Ut.	7916212
58	23	320	Verniciato bianco White painted	20 UN/Ut.	7918112
64	20	370	Verniciato bianco White painted	20 UN/Ut.	7916312
80	16	470	Verniciato bianco White painted	20 UN/Ut.	7918212

Acciaio  
Steel

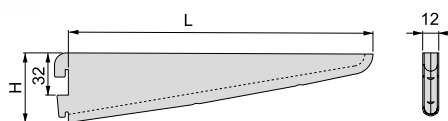



STRUTTURA TRAM // TRAM STRUCTURE

Profilo Tram per struttura Tram

Tram profile for Tram wardrobe systems

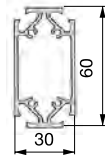

Lunghezza Longitude	Finitura Finishing	Imballo Packaging	Cod.
2,9 m	Anodizzato opaco Matt anodized	6 UN/Ut.	6112362

Alluminio  
Aluminium



Possibilità di personalizzare su misura.  
Can be cut to size.

Unione a 2 vie per struttura Tram

2-ways joint profiles for Tram wardrobe systems



x4

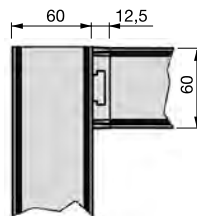

Finitura Finishing	Imballo Packaging	Cod.
Verniciato alluminio Silver painted	1 UN/Ut.	6109325

Zama  
Zamak



Unione a 3 vie per struttura Tram

3-ways joint profiles for Tram wardrobe systems

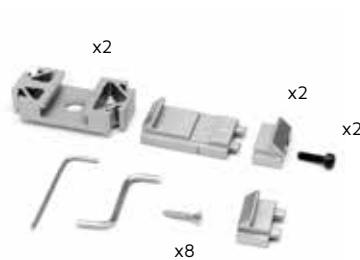

x8

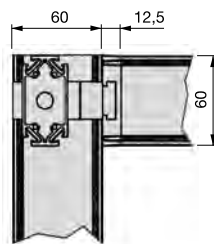

Finitura Finishing	Imballo Packaging	Cod.
Verniciato alluminio Silver painted	1 UN/Ut.	6109425

Zama  
Zamak

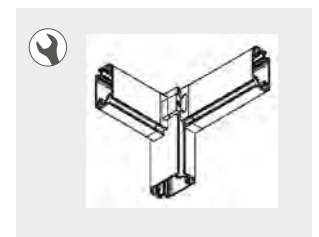

Unione a 4 vie per struttura Tram

4-ways joint profiles for Tram wardrobe systems

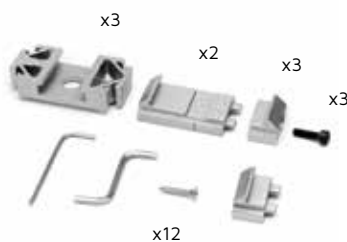

x12

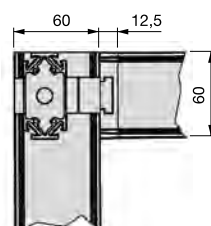

Finitura Finishing	Imballo Packaging	Cod.
Verniciato alluminio Silver painted	1 UN/Ut.	6128325

Zama  
Zamak

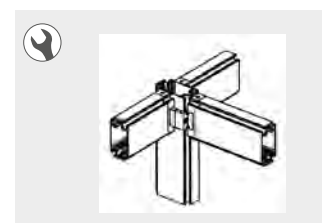

STRUTTURA TRAM // TRAM STRUCTURE

Regolabile per base e soffitto per struttura Tram

Fixing to floor / ceiling for Tram wardrobe systems

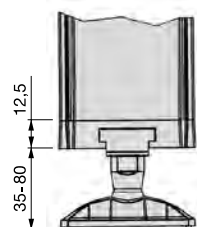

Finitura Finishing	Imballo Packaging	Cod.
Verniciato alluminio Silver painted	1 UN/Ut.	6115625

Tecnoplastica, Zama Plastic, Zamak

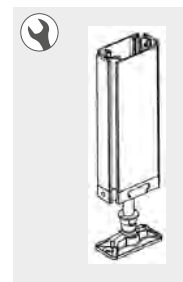

Fissaggio a muro per struttura Tram

Fixing to wall for Tram wardrobe systems

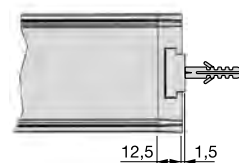

Finitura Finishing	Imballo Packaging	Cod.
Verniciato alluminio Silver painted	1 UN/Ut.	6111325

Zama Zamak

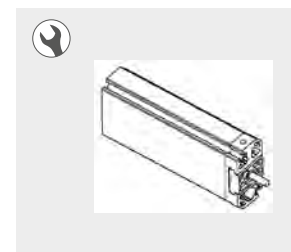

Tappo di chiusura per struttura Tram

Cover for Tram wardrobe systems



Finitura Finishing	Imballo Packaging	Cod.
Plastica grigia Grey plastic	10 UN/Ut.	6128421

Tecnoplastica Plastic





SUPPORTI PER STRUTTURA TRAM // SUPORTS FOR TRAM STRUCTURE

Reggipiano per legno per struttura Tram

For wood shelf for Tram wardrobe rail

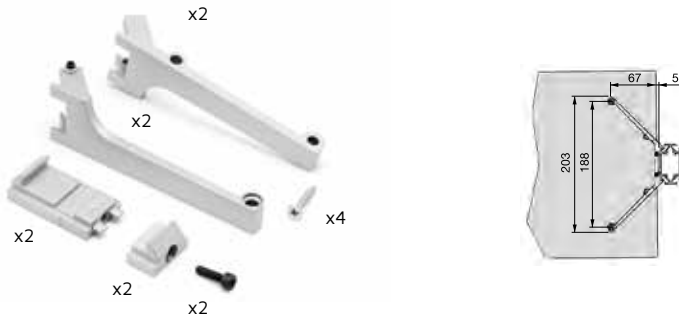

Finitura Finishing	Imballo Packaging	Cod.
Verniciato alluminio Silver painted	1 UN/Ut.	6104725

Zama Zamak

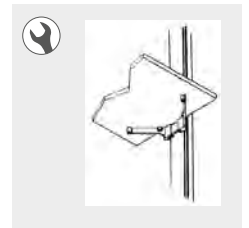

Reggipiano per vetro per struttura Tram

Glass shelf for Tram wardrobe rail



Finitura Finishing	Imballo Packaging	Cod.
Verniciato alluminio Silver painted	1 UN/Ut.	6105425

Zama Zamak

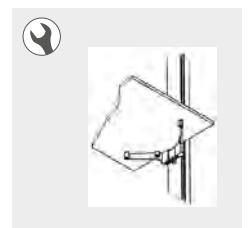

Reggipiano inclinabile per struttura Tram

Inclinable wood shelf for Tram wardrobe rail

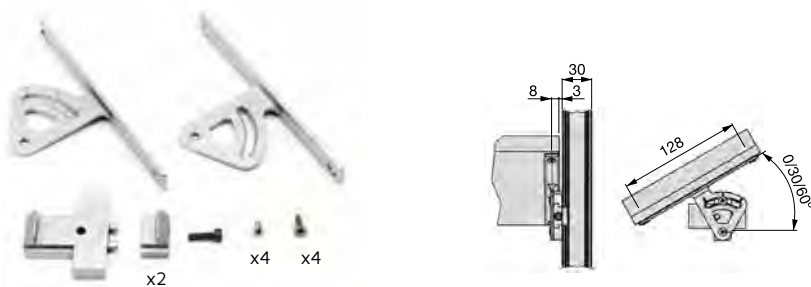

Finitura Finishing	Imballo Packaging	Cod.
Verniciato alluminio Silver painted	1 UN/Ut.	6107325

Zama Zamak

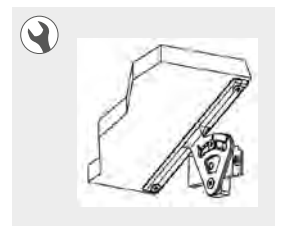

Supporto per modulo per struttura Tram

Module support for Tram wardrobe rail

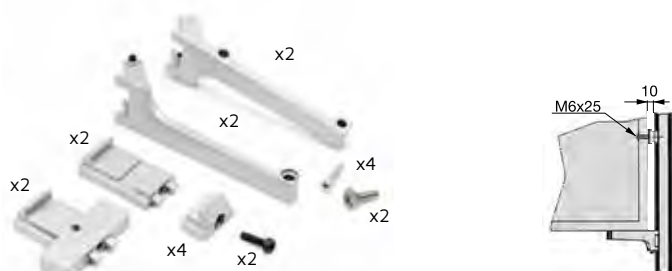

Finitura Finishing	Imballo Packaging	Cod.
Verniciato alluminio Silver painted	1 UN/Ut.	6116925

Zama Zamak



SUPPORTI PER STRUTTURA TRAM // SUPORTS FOR TRAM STRUCTURE

Supporto reggitubo per struttura Tram

Hanging rail support for Tram wardrobe rail

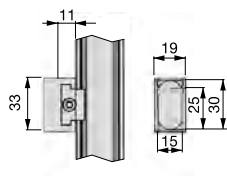
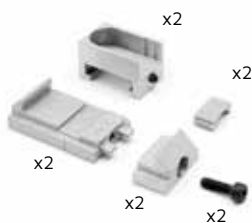

Finitura Finishing	Imballo Packaging	Cod.
Verniciato alluminio Silver painted	1 UN/Ut.	6109025

Zama  
Zamak

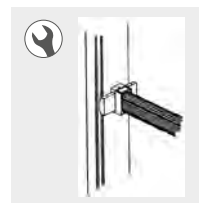

Supporto per appendiabiti Hang

Support for Hang wardrobe lift



Finitura Finishing	Imballo Packaging	Cod.
Verniciato alluminio Silver painted	1 UN/Ut.	6108225

Acciaio, Zama  
Steel, Zamak







“

ANTE IN ALLUMINIO

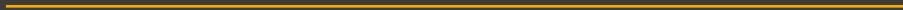

ALUMINIUM DOORS

”



PROFILI PLUS // PLUS PROFILES

Profili per ante Plus 4

Profile for cabinets Plus 4

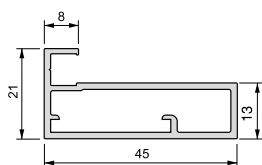

Lunghezza Longitude	Finitura Finishing	Imballo Packaging	Cod.
2,35 m	Anodizzato opaco Matt anodized	 8 UN/Ut.	6304362

Alluminio  
Aluminium

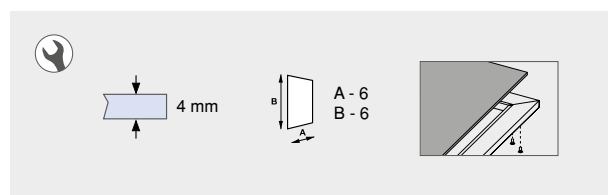

Possibilità di personalizzare su misura.  
Can be cut to size.

Profili per ante Plus 7

Profile for cabinets Plus 7

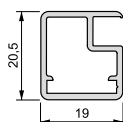

Lunghezza Longitude	Finitura Finishing	Imballo Packaging	Cod.
2,35 m	Anodizzato opaco Matt anodized	 20 UN/Ut.	7025262

Alluminio  
Aluminium

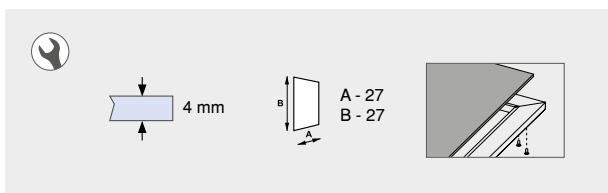

Possibilità di personalizzare su misura.  
Can be cut to size.

PROFILI PLUS // PLUS PROFILES

Profili per ante Plus 11

Profile for cabinets Plus 11

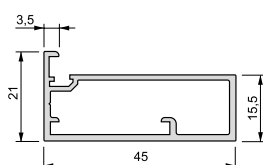

Lunghezza Longitude	Finitura Finishing	Imballo Packaging	Cod.
2,35 m	Anodizzato brillo Bright anodized	8 UN/Ut.	6300760
2,35 m	Anodizzato opaco Matt anodized	8 UN/Ut.	6300762

Alluminio  
Aluminium

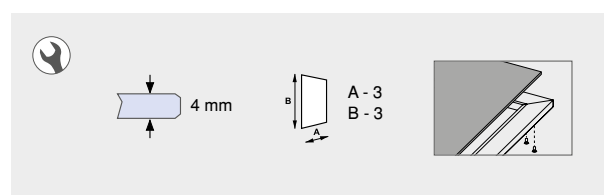

Possibilità di personalizzare su misura.  
Can be cut to size.

Profili per ante Plus 14 - Profilo superiore e inferiore 14+4

Profile for cabinets Plus 14 - 14+4 upper and lower profile

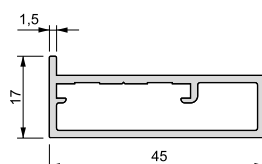
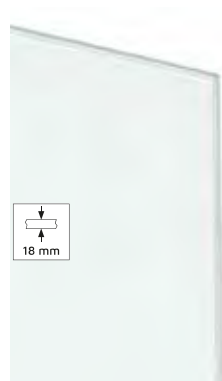

Lunghezza Longitude	Finitura Finishing	Imballo Packaging	Cod.
2,35 m	Anodizzato opaco Matt anodized	8 UN/Ut.	6304462

Alluminio  
Aluminium

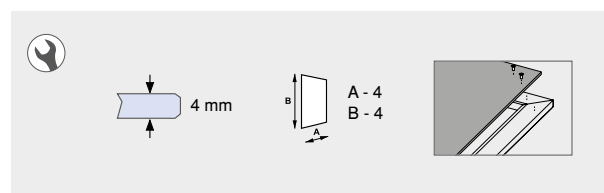

Possibilità di personalizzare su misura.  
Can be cut to size.

PROFILI PLUS // PLUS PROFILES

Profili per ante Plus 15

Profile for cabinets Plus 15

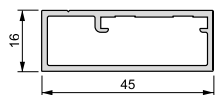

Lunghezza Longitude	Finitura Finishing	Imballo Packaging	Cod.
2,35 m	Anodizzato opaco Matt anodized	8 UN/Ut.	6304562

Alluminio  
Aluminium

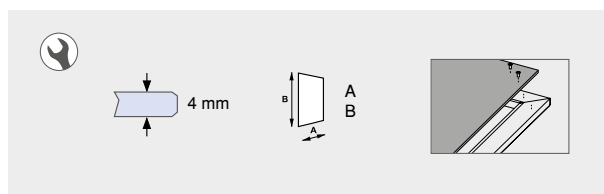

Possibilità di personalizzare su misura.  
Can be cut to size.

Profili per ante Plus 18

Profile for cabinets Plus 18

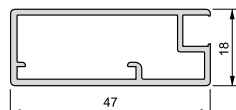

Lunghezza Longitude	Finitura Finishing	Imballo Packaging	Cod.
2,35 m	Anodizzato opaco Matt anodized	8 UN/Ut.	7026462

Alluminio  
Aluminium

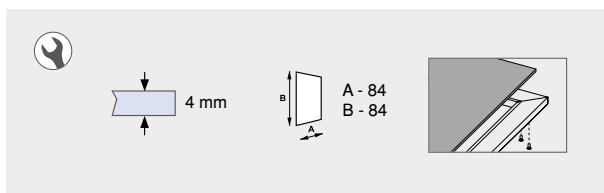

Possibilità di personalizzare su misura.  
Can be cut to size.

ACCESSORI PER PROFILI PLUS // ACCESSORIES FOR PLUS PROFILES

Kit ferramenta necessaria per il montaggio di un traverso Plus

Fittings for one crosspiece Plus



CALCOLO DELLE MISURE DEI VETRI DI ANTE CON TRAVERSI

Altezza =  $(H - B - (nT \times 3)) / (nT + 1)$   
 Larghezza =  $(A - B - (nV \times 3)) / (nV + 1)$

H = Altezza.  
 nT = Numero di travesi orizzontali.

A = Larghezza.  
 nV = Numero di travesi verticali.

B = 6 mm (Profili Plus 4).  
 B = 27 mm (Profili Plus 7).  
 B = 3 mm (Profili Plus 11).

CALCULATING SIZE OF GLASS FOR DOORS WITH CROSSPIECE

Height =  $(H - B - (nT \times 3)) / (nT + 1)$   
 Width =  $(A - B - (nV \times 3)) / (nV + 1)$

H = Height.  
 nT = Number of horizontal crosspieces.

A = Width.  
 nV = Number of vertical crosspieces.

B = 6 mm (Profiles Plus 4).  
 B = 27 mm (Profiles Plus 7).  
 B = 3 mm (Profiles Plus 11).

Finitura Finishing	Imballo Packaging	Cod.
Transparente / non classificata Transparent / not defined	20 UN/Ut.	6251820

Acciaio, Zama  
Steel, Zamak

Guarnizione per profili Plus 4 - 7 - 18

Gasket for Plus 4 - 7 - 18 profiles



Descrizioni Description	Lunghezza Longitude	Finitura Finishing	Imballo Packaging	Cod.
Guarnizione vetro 4 mm Gasket for 4 mm glass	2,35 m	Plastica grigia Grey plastic	20 UN/Ut.	7921021

Tecnoplastica  
Plastic

Guarnizione per profili Plus 11

Gasket for Plus 11 profiles



Descrizioni Description	Lunghezza Longitude	Finitura Finishing	Imballo Packaging	Cod.
Guarnizione vetro 4 mm Gasket for 4 mm glass	2,35 m	Transparente / non classificata Transparent / not defined	20 UN/Ut.	7922020

Tecnoplastica  
Plastic

Nastro adesivo per vetro Plus 14 - 15

Adhesive tape for glass Plus 14 - 15

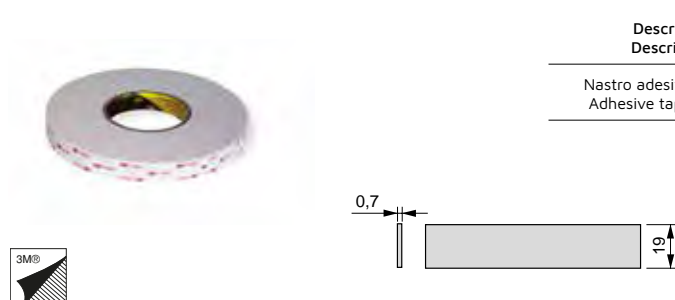

Descrizioni Description	Lunghezza Longitude	Finitura Finishing	Imballo Packaging	Cod.
Nastro adesivo per vetro Adhesive tape for glass	33 m	Plastica bianca White plastic	1 UN/Ut.	6000215

Tecnoplastica  
Plastic



ACCESSORI PER PROFILI PLUS // ACCESSORIES FOR PLUS PROFILES

Distanziale per maniglia per porte in vetro

Spacer for handles of doors with glass

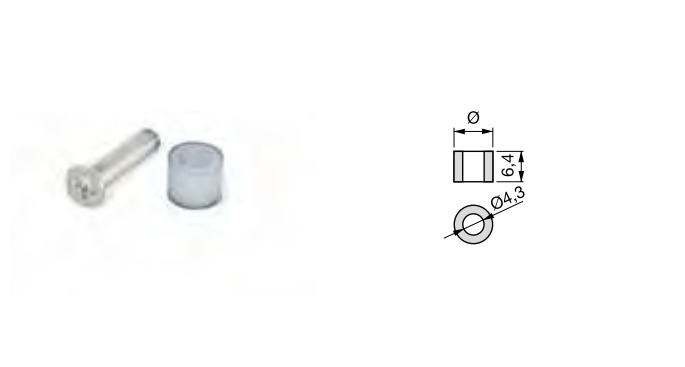

Diametro Diametre	Finitura Finishing	Imballo Packaging	Cod.
7,9	Transparente / non classificata Transparent / not defined		20 UN/Ut. 6227320

Tecnoplastica  
Plastic

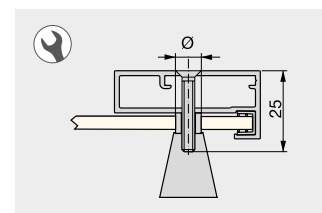

Squadre per profili Plus 7

Corners for Plus 7 profiles



Finitura Finishing	Imballo Packaging	Cod.
Transparente / non classificata Transparent / not defined		10 UN/Ut. 9984720

Acciaio  
Steel

Squadre per profili Plus 4 - 11 - 14 - 15 - 18

Corners for Plus 4 - 11 - 14 - 15 - 18 profiles



Finitura Finishing	Imballo Packaging	Cod.
Transparente / non classificata Transparent / not defined		10 UN/Ut. 9985520

Acciaio  
Steel

Squadre per profili Plus 11

Corners for Plus 11 profiles



Finitura Finishing	Imballo Packaging	Cod.
Transparente / non classificata Transparent / not defined		1 UN/Ut. 9985620

Acciaio  
Steel

ACCESSORI PER PROFILI PLUS // ACCESSORIES FOR PLUS PROFILES

Maniglia adesiva per mobile Tulip1

Tulip1 adhesive furniture handle

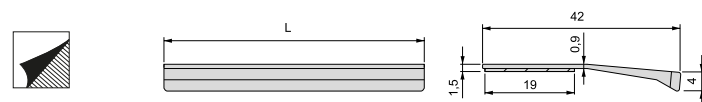

L	Finitura Finishing	Imballo Packaging	Cod.
62	Grigio antracite Anthracite grey	20 UN/Ut.	6920235
62	Anodizzato opaco Matt anodized	20 UN/Ut.	6920262
94	Anodizzato opaco Matt anodized	20 UN/Ut.	6920362
94	Grigio antracite Anthracite grey	20 UN/Ut.	6920335
126	Anodizzato opaco Matt anodized	20 UN/Ut.	6920462
126	Grigio antracite Anthracite grey	20 UN/Ut.	6920435
158	Grigio antracite Anthracite grey	20 UN/Ut.	6920535
158	Anodizzato brillo Bright anodized	20 UN/Ut.	6920560
158	Anodizzato opaco Matt anodized	20 UN/Ut.	6920562

Alluminio Aluminium

Maniglia adesiva per mobile Tulip2

Tulip2 adhesive furniture handle

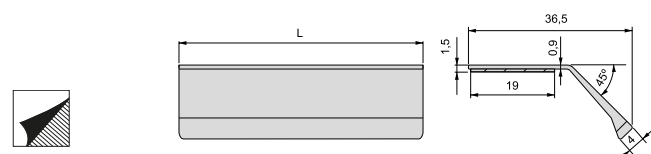

L	Finitura Finishing	Imballo Packaging	Cod.
62	Grigio antracite Anthracite grey	20 UN/Ut.	6920635
62	Anodizzato opaco Matt anodized	20 UN/Ut.	6920662
94	Anodizzato opaco Matt anodized	20 UN/Ut.	6920762
94	Grigio antracite Anthracite grey	20 UN/Ut.	6920735
126	Anodizzato opaco Matt anodized	20 UN/Ut.	6920862
126	Grigio antracite Anthracite grey	20 UN/Ut.	6920835
158	Grigio antracite Anthracite grey	20 UN/Ut.	6920935
158	Anodizzato brillo Bright anodized	20 UN/Ut.	6920960
158	Anodizzato opaco Matt anodized	20 UN/Ut.	6920962

Alluminio Aluminium



PORTE FREE // FREE DOORS

Porta Free standard: profili verticali

Standard Free door: vertical profile



Altezza Height	Anta Door	Finitura Finishing	Imballo Packaging	Cod.
2.350	A A	Anodizzato opaco Matt anodized	1 UN/Ut.	7026162
2.350	B B	Anodizzato opaco Matt anodized	1 UN/Ut.	7026262
2.350	C C	Anodizzato opaco Matt anodized	1 UN/Ut.	7026362

Alluminio  
Aluminium

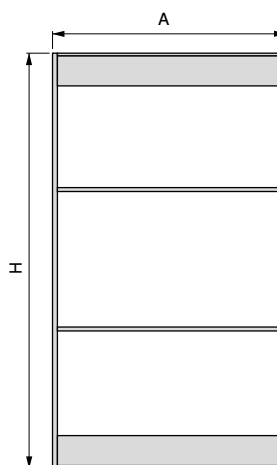

Possibilità di personalizzare su misura.  
Can be cut to size.

Si consegna con istruzioni di montaggio.  
I profili in alluminio che costituiscono questa porta vanno tagliati dritti, pertanto il cliente può tagliare le porte standard per creare porte su misura.  
Incluse istruzioni di montaggio.

Supplied ready for assembly.  
The aluminium profiles used for this door are straight-cut so the customer can cut standard doors to size.  
Mounting instruction included.

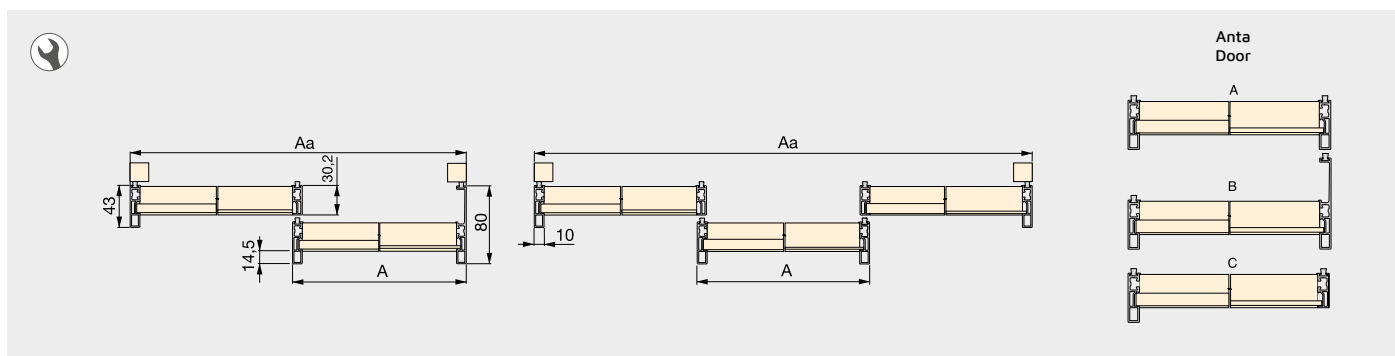

**Calcolo della ante**  
How to calculate the door

	Armadio 2 ante 2 doors wardrobe	Armadio 3 ante 3 doors wardrobe
A	$\frac{Aa + 8}{2}$	$\frac{Aa + 18}{3}$

	Space +	Glider 3
H	$H_a + 87$	$H_i - 8$

Ha = altezza totale armadio  
Ha = total height of wardrobe

Hi = altezza interna  
Hi = interior height

**Calcolo del vetro o pannello**  
How to calculate the glass or chipboard

	Vetro-4 / Pannello-11 Glass-4 / Board-11	Pannello-10 Board-10
Larghezza Width	A - 14	A - 13
Altezza Height	$\frac{H - 5,5 - (4 \times N)}{N + 1}$	$\frac{H - 4,5 - (3 \times N)}{N + 1}$

N = numero traversi  
N = Anzahl der Kreuzstücke



PORTE FREE // FREE DOORS

Porta Free standard: profili orizzontali

Standard Free door: horizontal profile



A	Descrizioni Description	Finitura Finishing	Imballo Packaging	Cod.
1200	Superiore e inferiore Upper and bottom	Anodizzato opaco Matt anodized	1 UN/Ut.	6908962
1600	Superiore e inferiore Upper and bottom	Anodizzato opaco Matt anodized	1 UN/Ut.	6909062
1200	Intermedio a vista Middle profile	Anodizzato opaco Matt anodized	2 UN/Ut.	6909162
1600	Intermedio a vista Middle profile	Anodizzato opaco Matt anodized	2 UN/Ut.	6909262

Alluminio  
Aluminium

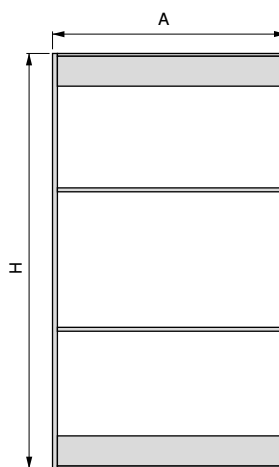

Possibilità di personalizzare su misura.  
Can be cut to size.

Si consegna con istruzioni di montaggio.  
I profili in alluminio che costituiscono questa porta vanno tagliati dritti, pertanto il cliente può tagliare le porte standard per creare porte su misura.  
Incluse istruzioni di montaggio.

Supplied ready for assembly.  
The aluminium profiles used for this door are straight-cut so the customer can cut standard doors to size.  
Mounting instruction included.

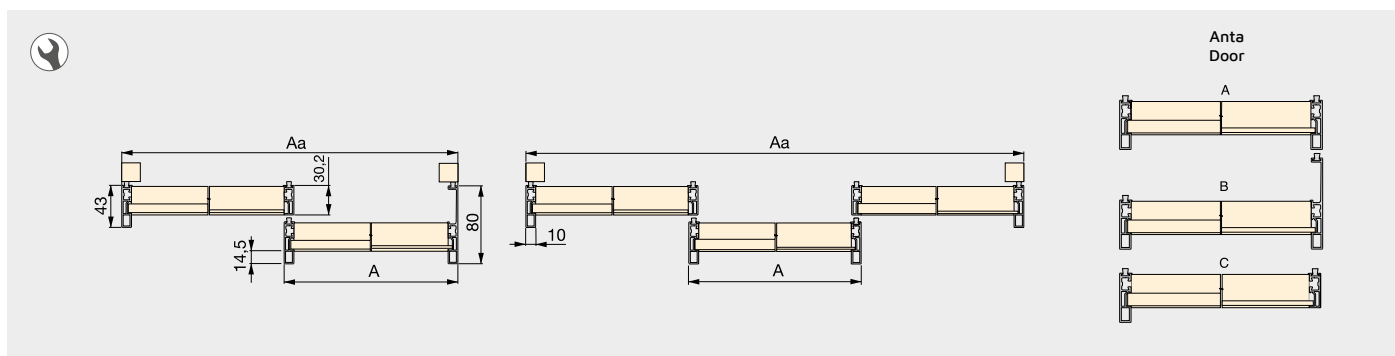

**Calcolo della ante**  
How to calculate the door

	Armadio 2 ante 2 doors wardrobe	Armadio 3 ante 3 doors wardrobe
A	$\frac{Aa + 8}{2}$	$\frac{Aa + 18}{3}$

	Space +	Glider 3
H	$Ha + 87$	$HI - 8$

Ha = altezza totale armadio  
Ha = total height of wardrobe

HI = altezza interna  
HI = interior height

**Calcolo del vetro o pannello**  
How to calculate the glass or chipboard

	Vetro-4 / Pannello-11 Glass-4 / Board-11	Pannello-10 Board-10
Larghezza Width	A - 14	A - 13
Altezza Height	$\frac{H - 5,5 - (4 \times N)}{N + 1}$	$\frac{H - 4,5 - (3 \times N)}{N + 1}$

N = numero traversi  
N = Anzahl der Kreuzstücke

PORTE FREE // FREE DOORS

Profili Free

Free profiles



Descrizioni Description	Lunghezza Longitude	Finitura Finishing	Imballo Packaging	Cod.
Maniglia Handle	2,6 m	Anodizzato opaco Matt anodized	12 UN/Ut.	6909462
Maniglia-spalla Handle with wing	2,6 m	Anodizzato opaco Matt anodized	6 UN/Ut.	6909562
Verticale Vertical	2,6 m	Anodizzato opaco Matt anodized	12 UN/Ut.	6909362
Superiore / Inferiore Upper / Bottom	2,35 m	Anodizzato opaco Matt anodized	6 UN/Ut.	7025062
Intermedio a vista Middle profile	2,35 m	Anodizzato opaco Matt anodized	12 UN/Ut.	7025162
Intermedio nascosto Middle profile	2,35 m	Anodizzato opaco Matt anodized	12 UN/Ut.	6304262
Guarnizione per vetro 4 mm Gasket for 4 mm glass	2,35 m	Plastica grigia Grey plastic	20 UN/Ut.	7920021

Alluminio, Tecnoplastica  
Aluminium, Plastic



Possibilità di personalizzare su misura.  
Can be cut to size.



Calcolo della misura dei profili:  
Verticale = H  
Orizzontale = A - 20 mm

How to calculate the profiles:  
Vertical = H  
Horizontal = A - 20 mm

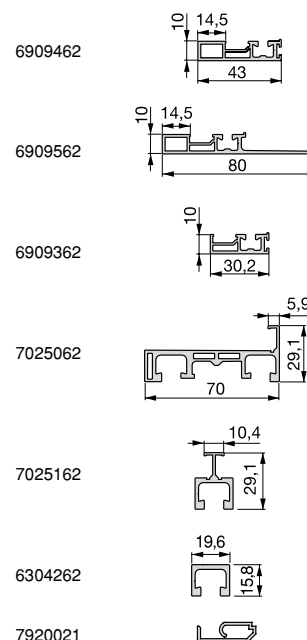

PORTE FREE // FREE DOORS

Ferramenta per montaggio di una porta Free

Fittings for one door Free



Descrizioni Description	Impostato Set	Finitura Finishing	Imballo Packaging	Cod.
Space + Space +	1 Traverso 1 Cross-piece	Transparente / non classificata Transparent / not defined	<input type="checkbox"/>	1 UN/Ut. 7016820
Space + Space +	2 Traversi 2 Cross-pieces	Transparente / non classificata Transparent / not defined	<input type="checkbox"/>	1 UN/Ut. 7016920
Space + Space +	3 Traversi 3 Cross-pieces	Transparente / non classificata Transparent / not defined	<input type="checkbox"/>	1 UN/Ut. 7017020

Acciaio, Alluminio, Zama  
Aluminium, Steel, Zamak

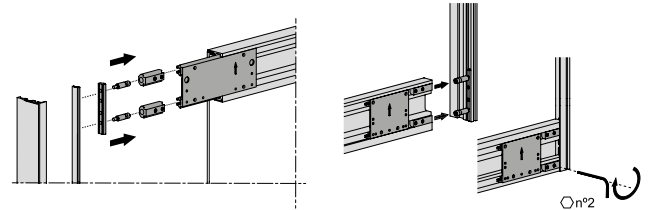
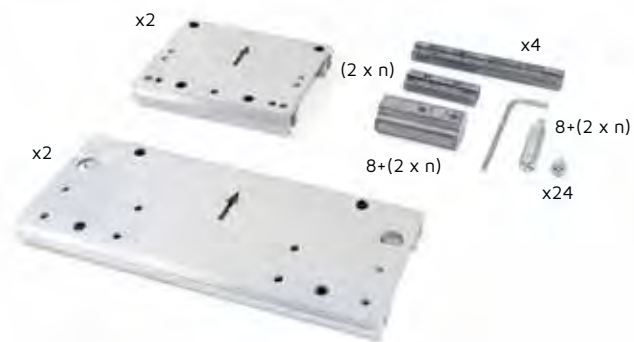

Unione T per porte armadio Free

T Link for Free wardrobe doors

Finitura Finishing	Imballo Packaging	Cod.
Transparente / non classificata Transparent / not defined	<input type="checkbox"/>	1 UN/Ut. 6100620

Vari  
Various

